

Operating Instructions (Household use) Rechargeable Shaver

Model No. ES-PV6B
ES-PV3B

Contents

Safety precautions	2	Replacing the system outer foil and the inner blades	15
Important information	6	Troubleshooting	16
Parts identification	8	Battery life	18
Charging the shaver	9	Removing the built-in rechargeable battery	18
How to use	10	Specifications	19
Cleaning the shaver	13		

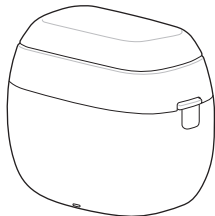

Thank you for purchasing this Panasonic product.

Before operating this unit, please read these instructions completely and save them for future use.

Safety precautions

Make sure to follow these instructions.

To prevent accidents, injuries or damage to property, please follow the instructions below.

- **The following chart indicates the degree of damage caused by improper operation.**



DANGER

Indicates a potential hazard that will result in serious injury or death.



WARNING

Indicates a potential hazard that could result in serious injury or death.



CAUTION

Indicates a potential hazard that could result in minor injury or property damage.

- **The symbols are classified and explained as follows.**



This symbol indicates prohibition.



This symbol indicates requirement that must be followed.

WARNING

► This product

This product has a built-in rechargeable battery. Do not throw into fire, apply heat, or charge, use, leave, or store in a high temperature environment.

- Doing so may cause overheating, ignition, or explosion.



Do not modify or repair.

- Doing so may cause fire, electric shock, or injury.

Contact an authorized service centre for repair (replacement of battery etc).



Never disassemble except when disposing of the product.

- Doing so may cause fire, electric shock, or injury.



► Power supply

Do not use in a way that would exceed the rating of the household outlet or the wiring.

- Exceeding the rating by connecting too many plugs to one household outlet may cause fire due to overheating.



Fully insert the power plug of USB power adaptor.

- Failure to do so may cause fire or electric shock.



WARNING



Disconnect the USB plug when cleaning the main body with water.

- Failure to do so may cause electric shock or injury.

▶ **USB power adaptor/USB cable**

Do not immerse them in water or wash with water.

Do not place them over or near water filled sink or bathtub.



Never use them if they are damaged or if the power plug fits loosely in a household outlet. Do not damage them.

• **Do not deface, modify, forcefully bend or pull them. Also, do not place anything heavy on, twist or pinch them.**

- Doing so may cause electric shock or fire due to a short circuit.

Do not use anything other than the supplied USB power adaptor or USB cable for any purpose. Also, do not use any other product with the USB power adaptor or USB cable. (See page 8.)



- Doing so may cause burn or fire due to a short circuit.



Do not connect or disconnect them to a household outlet with a wet hand.

- Doing so may cause electric shock or injury.

Regularly clean them to prevent dust from accumulating.



- Failure to do so may cause fire due to insulation failure caused by humidity. Remove the USB power adaptor and wipe it with a dry cloth.

▶ **In case of an abnormality or malfunction**

Immediately stop using and remove the USB power adaptor.

- Failure to do so may cause fire, electric shock, or injury.

<Abnormality or malfunction cases>



• **The main unit, USB power adaptor or USB cable is deformed or abnormally hot.**

• **The main unit, USB power adaptor or USB cable smells of burning.**

• **There is an abnormal sound during use or charging of the main unit.**

- Immediately request inspection or repair at an authorized service centre.

▶ **Preventing accidents**

Persons using an implanted medical electronic device, such as a pacemaker, should not allow this product to be in the vicinity of where the medical electronic device is implanted.



- Doing so may cause an accident or illness.

WARNING



Do not place within reach of children or infants. Do not let them use it.

- Putting parts or accessories in the mouth may cause an accident or injury.

If oil is consumed accidentally, do not induce vomiting, drink a large amount of water and contact a physician.



If oil comes into contact with eyes, wash immediately and thoroughly with running water and contact a physician.

- Failure to follow these instructions may result in physical problems.

- **Take care of the following precautions as well**
This appliance is not intended for use by persons (including children) with reduced physical, sensory or mental capabilities, or lack of experience and knowledge, unless they have been given supervision or instruction concerning use of the appliance by a person responsible for their safety. Children should be supervised to ensure that they do not play with the appliance.
- Failure to do so may cause an accident or injury.

CAUTION

► **Protecting the skin**

Do not forcefully press the system outer foil. Also, do not touch the system outer foil with fingers or nails when in use.



Do not use this product for hair on head or any other part of the body.

- Doing so may cause injury to skin or reduce the life of the system outer foil.

Do not use excessive pressure to apply the system outer foil to your lip or other part of your face.



Do not apply the system outer foil directly to blemishes or injured skin.

Do not touch the blade section (metallic section) of the inner blade.

- Doing so may cause injury to skin or hand.



Check the system outer foil for cracks or deformations before use.

- Failure to do so may cause injury to the skin.

► **Note the following precautions**

Do not allow metal objects or trash to adhere to power plug of USB power adaptor or USB plug.



- Doing so may cause electric shock or fire due to a short circuit.

CAUTION



Do not charge when the appliance socket is wet.
- Doing so may cause electric shock or fire.



Do not share your shaver with your family or other people.
- Doing so may result in infection or inflammation.



Disconnect the USB power adaptor from the household outlet when not charging.
- Failure to do so may cause electric shock or fire due to electrical leakage resulting from insulation deterioration.

Handling of the removed battery when disposing



DANGER



- The rechargeable battery is exclusively for use with this appliance. Do not use the battery with other products.
- Do not charge the battery after it has been removed from the product.
- Do not throw into fire or apply heat.
- Do not hit, disassemble, modify, or puncture with a nail.
- Do not let the positive and negative terminals of the battery get in contact with each other through metallic objects.
- Do not carry or store the battery together with metallic jewellery such as necklaces and hairpins.
- Do not use or leave the battery where it will be exposed to high temperatures, such as under direct sunlight or near other sources of heat.
- **Never peel off the tube.**
- Doing so may cause overheating, ignition, or explosion.

WARNING

After removing the rechargeable battery, do not keep it within reach of children and infants.



- The battery will harm the body if accidentally swallowed.

If this happens, consult a physician immediately.

If the battery fluid leaks out and comes in contact with the eyes, do not rub the eyes, and thoroughly rinse with clean water, such as tap water.



- Failure to do so may cause eye injury.

Consult a physician immediately.

CAUTION

If the battery fluid leaks out and comes in contact with the skin or clothes, rinse off with clean water, such as tap water.



- Failure to do so may cause inflammation.

Important information

- This WET/DRY shaver can be used for wet shaving using shaving lather or for dry shaving. You can use this watertight shaver in the shower and clean with water. The following symbol means suitable for use in a bath or shower.



- Treat yourself to wet lather shaves for at least three weeks and notice the difference. Your Panasonic WET/DRY shaver requires a little time to get used to because your skin and beard need about a month to adjust to any new shaving method.
- Keep both the inner blades inserted. If only one of the inner blades is inserted, the shaver may be damaged.
- If you clean the shaver with water, do not use salt water or hot water. Do not soak the shaver in water for a long period of time.
- Charge the appliance correctly according to these Operating Instructions. (See page 9 "Charging the shaver".)
- This appliance contains battery that is only replaceable by skilled persons. Please contact an authorized service centre for the details of repair.
- Do not recharge non-rechargeable batteries.

- The following symbol indicates that a specific detachable power supply unit is required for connecting the electrical appliance to the supply mains. The type reference of power supply unit is marked near the symbol.



Note the following precautions in order to prevent malfunction, deformation and deterioration

- Do not drop or hit against other objects.
- Do not bring the system outer foil into contact with hard objects.
- Do not leave the shaver exposed to direct sunlight with the foil frame detached.
- Do not dry using heat from a dryer or other appliance.
- Be sure to place the protective cap on the shaver when carrying around or storing.
- Store the shaver in a place with low humidity after use.

Parts identification

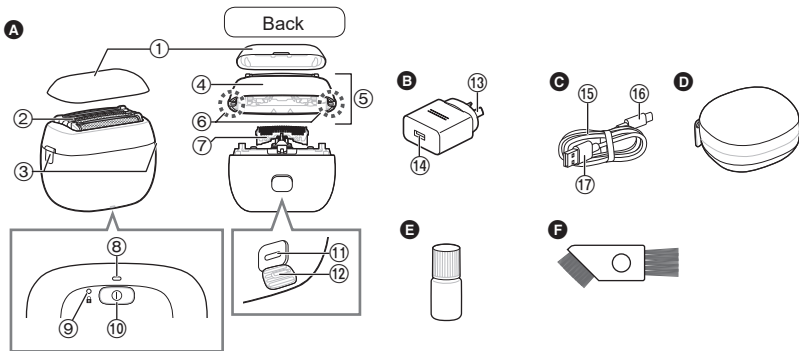

A Main body

- ① Protective cap
- ② System outer foil
- ③ Foil frame release buttons
- ④ Foil frame
- ⑤ Outer foil section
- ⑥ System outer foil release buttons
- ⑦ Inner blades
- ⑧ Charge status lamp
- ⑨ Switch lock lamp ()
- ⑩ Power switch

- ⑪ Appliance socket (Type-C)
- ⑫ Socket cover

B USB power adaptor for general use (ES-RU1-02)

- ⑬ Power plug
- ⑭ USB port (Type-A)

C USB cable

- ⑮ Cord
- ⑯ USB plug (Type-C)
- ⑰ USB plug (Type-A)

Accessories

- D** Travel case
- E** Oil
- F** Cleaning brush

Charging the shaver

- Turn the shaver off.
- Wipe off any water droplets on the appliance socket.
- Use the specified USB power adaptor and USB cable.

1 Open the socket cover and insert the USB plug firmly into the main body and USB power adaptor.

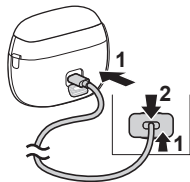

2 Insert the USB power adaptor firmly into a household outlet.

- Check that the charge status lamp is glowing.
- Charging is completed after approx. 2 hours.

3 Remove the USB power adaptor from the household outlet, and remove the USB plug from the main body after the charge status lamp turns off.

- Close the socket cover.

Note

You cannot operate the shaver while charging.

► When the battery capacity is low

- The appliance beeps twice after switched off.
 - The charge status lamp blinks once every second when operating the shaver.
- You can shave 2 to 3 times after the charge status lamp blinks. (This will differ depending on usage.)



► Notes

- Panasonic's specified adaptor with splash-resistant design and a USB cable with an overheating protection feature should be used to ensure safety. The adaptor is not completely waterproof, so prevent it from getting wet.
- After charging is completed, turning the power switch ON with the shaver plugged in will cause the charge status lamp to light up and then turn off after 5 seconds.
- If there is noise from the radio or other sources while using or charging the appliance, move to a different location to use the appliance.
- The battery will become deteriorated even when it has not been in use for a long period of time (6 months or more), so charge it fully once every 6 months.

- When charging the shaver for the first time or when it has not been in use for more than 6 months, the charging time may change or the charge status lamp may not glow for a few minutes. It will eventually glow if kept connected.
- Recommended ambient temperature for charging is 10 °C – 35 °C. It may take longer to charge or the battery may fail to charge properly in extremely high or low temperatures.
The charge status lamp will blink twice every second when there is a problem with charging.
Charge the shaver within the recommended ambient temperature range.
- The shaver can be used for approximately 2 weeks with a full charge. (Based on one 3-minute dry-shave usages per day in an ambient temperature range of 20 °C – 30 °C.)
The number of usable days varies depending on the following conditions.
 - Beard thickness
 - Pressure applied to the skin
 - Usage in shaving foam mode
 - Usage of wet shaving
- Charging each time does not affect battery life, because it uses a lithium-ion battery.
- To keep charging the battery will not affect battery performance.

How to use

► Usable facial cleansers, etc.

		Shaving	Shaving foam mode
Shaving agent	Shaving foam	✓	—
	Shaving gel	✓	✗
	Shaving cream	✗	✗
Facial cleanser	Facial cleansing foam (without scrubbing compounds)	✓	✓
	Facial cleansing foam (with scrubbing compounds)	✗	✗
	Facial soap	✓	✗
Body soap etc.	Liquid	✓	✓
	Foam	✓	—

- Do not use anything other than above listed shaving agent/facial cleanser/body soap etc. as these may cause the blades to clog, or be unable to make foam.

Making foam in shaving foam mode

It is easier to make foam this way than by hand.

- Check the system outer foil for cracks or deformations before use.
- Check that the socket cover is closed.

1 Preparing foam

Scoop a suitable amount of facial cleanser or similar in your hand, and add a suitable amount of cold or warm water.

2 Hold for 2 seconds or more to switch to shaving foam mode.



The switch lock lamp () and charge status lamp blink alternately.



- The shaving foam mode ends after 15 seconds. The shaver can then be used to shave.
- To stop using the shaving foam mode and start shaving, press the power switch once.

3 Press the blades gently in the palm of your hand, mix the facial cleanser etc. around and move the blades up and down to make foam.

- If there is insufficient foam, add slightly more water, hot water or facial cleanser etc. to make it easier to create foam.



► Notes

- Do not use shaving agent (excluding foam), facial cleansing foam (with scrubbing compounds) or soap as these may cause the blades to clog, or be unable to make foam.

Shaving beard

1 Press and shave.



The “shaving sensor”, which automatically adjusts the power depending on the beard thickness, will operate. It will shave with high power on areas where the beard is heavy, and reduce the power on areas where the beard is thin, to reduce burden on the skin.

Tips for better shaving

Apply the whole system outer foil perpendicularly against the skin and shave by slowly gliding the shaver over the face against the grain of the beard.

- The beard under the chin and around the throat can be shaved better by stretching the skin so the beard will stand.

- To prevent damaging the system outer foil, do not shave with only a part of the system outer foil.

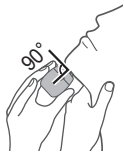

2 Press when finished.

► Notes

- The appliance may not operate in an ambient temperature lower than approximately 5 °C.
- The shaving sensor may not respond depending on the type and quantity of the shaving gel or the quantity of the foam. This is not abnormal.
- After wet shaving, wash the main body with water and apply oil to the system outer foil.



Operation and display of the switch lock

► Locking the power switch

1. Press  once and then release.

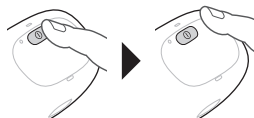
- The shaver starts operating.



2. Hold  for more than 2 seconds until the switch lock lamp () turns on.

- The shaver will stop operating.





3. Release .

- The switch lock lamp () will turn off after 5 seconds.



► Unlocking the power switch

1. Hold  for more than 2 seconds until the switch lock lamp () turns off.

- The switch lock lamp () will turn off.
- The shaver starts operating.

2. Release .

The power switch is locked when the switch lock lamp () blinks for 5 seconds and the shaver does not operate even though the power switch is pressed.



Cleaning the shaver



- We recommend cleaning the shaver after each use.
- Turn the shaver off and disconnect the USB plug.
- Check that the socket cover is closed.



Cleaning with water

1 Apply some hand soap and some water to the system outer foil.



2 Press  and make foam for several seconds, then press  to stop making foam.

3 Remove the outer foil section and clean with running water.



- See page 15 for removing the outer foil section.

4 After rinsing with water, shake the shaver up and down for a few times to remove excess moisture and then wipe off any drops of water with a dry cloth.

5 Dry the outer foil section and the shaver completely.

- Allow the shaver to dry in the shade, avoid direct sunlight.

6 Lubricate the shaver.

1. Apply one drop of oil to each of the system outer foils.
2. Switch the shaver on, and run it for approximately five seconds.
3. Switch off the shaver, and wipe off any excess oil from the system outer foil with a soft cloth.



Notes

- Be careful not to hit the main body on the sink or any other object while draining the water. Failure to do so may cause malfunction.
- Do not wipe with thinners, benzine, alcohol etc. Doing so may cause malfunction, cracking or discoloration of the parts. Wipe with diluted soapy water.
- Do not use any kitchen or bathroom detergents other than hand soap. Doing so may cause malfunction.

Cleaning with the brush

Remove the outer foil section and the inner blades. (See page 15.)

Do not use any brush other than the supplied one.

► Cleaning with the short brush

- Clean the inner blades using the short brush by moving it in direction as illustrated.
- Do not move the short brush perpendicularly against the blades as it will damage the inner blades and affect their sharpness.



► Cleaning with the long brush

Clean the foil frame, system outer foil and the main body using the long brush.



► System outer foil

Clean the system outer foil in the areas indicated by the circles every time you use the shaver. Otherwise, abnormal sound may be generated.



Replacing the system outer foil and the inner blades

system outer foil	Approximately once every year*
inner blades	Approximately once every two years*

* The replacement timing is a recommendation and is subject to individual usage and preference. Do not throw away the foil frame.

► Removing the outer foil section

Press the foil frame release buttons and lift the outer foil section upwards.

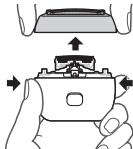

► Attaching the outer foil section

Align the foil frame (▲) and the main body (●) marks, and securely attach it evenly until it clicks.

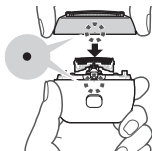

► Replacing the system outer foil

1. Press the system outer foil release buttons and pull down the system outer foil.

- Do not press the system outer foil release buttons with excessive force.

Doing so may bend the system outer foil, preventing complete attachment to the foil frame.

2. Align the foil frame (▲) and the system outer foil (▲) marks, and attach it until it clicks.

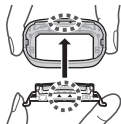

► Replacing the inner blades

1. Remove the inner blades one at a time.
2. Insert the inner blades one at a time.

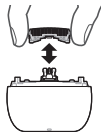

► Replacement parts

Replacement parts are available at your dealer or Service Centre.

Replacement parts for ES-PV6B/ES-PV3B	System outer foil and inner blades	WES9040
	System outer foil	WES9181
	Inner blades	WES9170

Troubleshooting

Perform the following actions.

If the problems still cannot be solved, contact the store where you purchased the unit or a service centre authorized by Panasonic for repair.

Problem	Action
The power switch does not turn ON.	▶ Unlock the switch lock. (See page 12.)
The power will not switch to OFF.	▶ Press the power switch twice while using in shaving foam mode.

Problem	Action
The shaving sensor does not respond.	The shaving sensor may not respond when the remaining battery capacity is low. If this happens, recharge the shaver.
	Apply oil. (See page 14.) The shaving sensor may not respond when there is not enough oil on the blades.
	Depending on the beard thickness or the amount of beard trimmings in the shaver head, the shaving sensor may not react and the driving sound may not change. This is not abnormal.
	The shaving sensor may not respond depending on the type and quantity of the shaving gel. This is not abnormal.

Problem	Action
The shaving sensor responds even though the shaver is not in contact with the skin.	<ul style="list-style-type: none"> ▶ Clean the beard trimmings from the shaver. ▶ Clean the system outer foil with the brush. (See page 14.) ▶ When the shaver is extremely dirty, remove the foil frame and wash with water. (See page 13.) ▶ Replace the system outer foil and/or inner blades.
Foam cannot be made in shaving foam mode.	<ul style="list-style-type: none"> ▶ Making foam may be difficult depending on the type of facial cleansers etc., so adjust the amount of water or facial cleanser.
Foam made in shaving foam mode contains shavings.	<ul style="list-style-type: none"> ▶ Before making foam, cleanly rinse off any shavings. (See page 13.)

Problem	Action
Operating time is short even after a full charge.	▶ When the number of operations per charge starts to decrease, the battery is nearing the end of its life.
	▶ Apply oil.
	▶ Clean the shaver.
Shaver does not operate even after charging.	▶ The usable number of days might be lower depending on how the shaver is used (for example, when used for wet shaving).
	▶ The shaver will not operate while it is connected to the household outlet.
The driving sound changes while shaving.	▶ Use the appliance in an ambient temperature approximately 5 °C or higher.
	▶ The battery has reached the end of its life.
	▶ The shaving sensor is operating. The sound changes depending on the beard thickness.

Problem	Action
Makes a loud sound.	▶ Apply oil. The blades will not move smoothly when there is no oil on the blades, requiring more power.
	▶ The shaver makes a high-pitched sound due to the linear motor drive. This does not indicate a problem.
	▶ Confirm that the blades are properly attached.
	▶ Clean the system outer foil with the brush. (See page 14.)
The odor is getting stronger.	▶ Clean the shaver.
Shavings fly out in all directions.	▶ Clean the inner blades with the brush when shavings are adhering to the inner blades.
System outer foil gets hot.	▶ Apply oil.
	▶ Replace the system outer foil if it is damaged or deformed. (See page 15.)

Problem	Action
You do not get as close a shave as before.	▶ Clean the shaver.
	▶ Apply oil.
	▶ This can be improved by replacing the outer foil and/or inner blades.

Battery life

The life of the battery is 3 years. The battery in this shaver is not intended to be replaced by consumers. Have the battery replaced by an authorized service centre.

Removing the built-in rechargeable battery

Remove the built-in rechargeable battery before disposing of the shaver.

The battery is to be disposed of safely.

Please make sure that the battery is disposed of at an officially designated location if there is one.

This figure must only be used when disposing of the shaver, and must not be used to repair it. If you dismantle the shaver yourself, it will no longer be waterproof, which may cause it to malfunction.

- Remove the shaver from the USB plug.

- Press the power switch to turn on the power and then keep the power on until the battery is completely discharged.
- Perform steps ① to ⑤ and lift the battery, and then remove it.
- Use a flat head screwdriver as shown.
- Take care not to short circuit the positive and negative terminals of the removed battery, and insulate the terminals by applying tape to them.

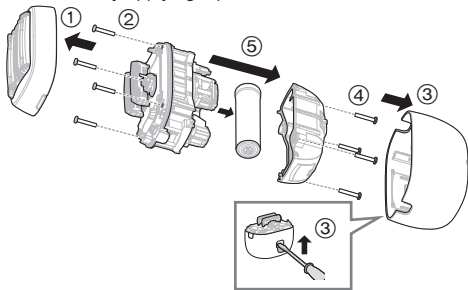

For environmental protection and recycling of materials

This shaver contains a Lithium-ion battery.

Please make sure that the battery is disposed of at an officially assigned location, if there is one in your country.

Specifications

Power supply	See the name plate on the USB power adaptor. (Automatic voltage conversion)
Motor voltage	3.6 V $\overline{\text{---}}$
Charging time	Approx. 2 hours

This product is intended for household use only.

Panasonic Corporation
<https://www.panasonic.com>
© Panasonic Corporation 2024