

OPERATING INSTRUCTIONS

Air Purifier

Model No. **F-PXV35M**

This product is for indoor use only

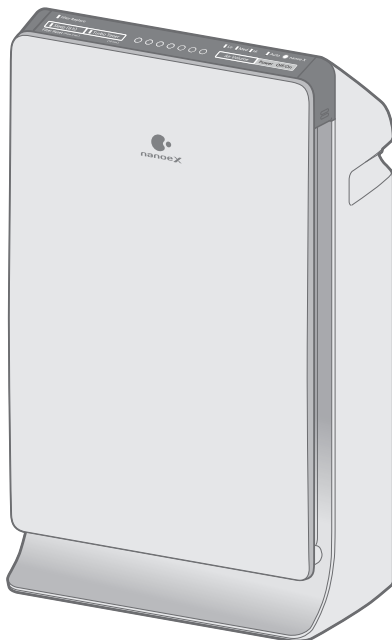

CONTENTS

SAFETY PRECAUTIONS	2~4
SETTING AND OPERATING REQUIREMENTS	4
PRODUCT FEATURES	5
MAIN PARTS IDENTIFICATION	5~6
SETUP	6~7
<hr/>	
OPERATION	7~8
• POWER OFF/ON	7
• AIR VOLUME • TURBO TIMER • SLEEP	8
<hr/>	
MAINTENANCE	8~10
• CLEANING METHOD	9
• FILTER REPLACEMENT	9
• WHEN IDLE FOR A LONG TIME	10
<hr/>	
FURTHER INFORMATION	10
FAQ	11
TROUBLESHOOTING	11
SPECIFICATIONS	BACK COVER
OPTIONAL ACCESSORIES	BACK COVER

CONFIRMATION
AND SETUP

OPERATION

MAINTENANCE

OTHER
INFORMATION

Warranty card attached

Thank you very much for purchasing this **Panasonic** product.

Please read these operating instructions carefully before operation and maintenance.

Also, be sure to read the "SAFETY PRECAUTIONS" section (P.2~4) before use.

Failure to comply with instructions could result in injury or property damage.

Make sure that the correct information is written on the warranty card, including the date of purchase and the name of the distributor. Keep the warranty card in a safe place along with the operating instructions for future reference.

SAFETY PRECAUTIONS

Please strictly follow

- Disconnect power supply before maintenance.
- If the supply cord is damaged, it must be replaced by the manufacturer, its service agent or similarly qualified persons in order to avoid a hazard.
- This product is not intended for use by persons (including children) with reduced physical, sensory or mental capabilities, or lack of experience and knowledge, unless they have been given supervision or instruction concerning use of the product by a person responsible for the safety. Children should be supervised to ensure that they do not play with the product.

The safety precautions should be strictly followed in order to prevent injury or damage to properties.

- The following symbols differentiate the levels of danger and injury that may result if the product is not used correctly as instructed.



WARNING

Those things shown in this column indicate that there is possibility of causing death or severe injury.



CAUTION

Those things shown in this column indicate that there is possibility of causing minor injury or damage to properties.

- The following symbols are used to indicate the type of instructions that need to be followed. (The symbols given below are examples)



This symbol indicates an action that must not be performed.



This symbol indicates an action that must be performed.



WARNING



- **Do not pull the power cord when carrying or storing the product.**

(Otherwise, the power cord may be damaged with the possibility of fire or electric shock.)

- **Do not damage the power cord or power plug.**

- Do not cut, modify, excessive distort, twist, squeeze the power cord, and do not place it near heat sources, place heavy weight on it, etc.

(Otherwise, the power cord may be damaged with the possibility of fire or electric shock.)

- **Do not insert your fingers, metallic objects or others into the air inlet, air outlet or gaps.**

(Otherwise, you may be hurt by the inner units with the possibility of electric shock or injury.)



- **Do not let the product get wet.**

- Do not place cups, etc. on the product.

(Otherwise, the product may short circuit with the possibility of fire or electric shock.)



- **Do not use power other than the rated voltage.**

(Otherwise, the power cord may overheat and induce fire.)

- **Do not touch the power plug with wet hands.**

(Otherwise, electric shock may occur.)



- **Do not disassemble or modify the product.**

(Otherwise, the product may catch fire or malfunction, thus resulting in fire or electric shock.)

→ Contact the dealer for repair.



WARNING



■ Clean the power plug regularly.

(If dust is found on the power plug, insulation may be damaged by humidity and fire may occur.)

- Disconnect the power plug and wipe it with dry cloth.
- When the product will not be used for a long period, disconnect the power plug.

■ Insert the power plug completely.

(If the power plug is not fully inserted, the power cord may be overheated, thus resulting in fire or electric shock.)

- Do not use damaged power plug or loose power socket.



■ In case of any abnormality or malfunction, stop using the product immediately and disconnect the power plug.

(Otherwise, electric shock, fire or smoke may occur.)

<Examples of abnormality/ malfunction

- The product stops operating when moving the power cord.
 - If any switches do not work.
 - If the circuit breaker is tripped or when fuse blows.
 - If the power cord or power plug becomes abnormally hot.
 - If you notice a burning smell or an abnormal sound or vibration.
 - If there is any other abnormalities or malfunction.
- Please stop using the product immediately and disconnect the power plug, and contact the dealer to check and repair.



CAUTION



■ Do not place the product in the following places.

- Incline and unstable place.
(Otherwise, the product may fall over and injury may occur or damage the product.)
- Where the temperature or humidity is extremely high, or watery area, such as bathroom.
(Otherwise, current may leak with the possibility of fire or electric shock.)
- Where oil fume is emitted, such as in kitchens.
(Otherwise, the product may crack and injury may occur.)
- Where oil or inflammable gas is present and may be leaked.
(Otherwise, a fire may occur due to ignition in the product.)
- Where the air outlet faces animals or plants directly.
(Otherwise, it may cause discomfort to the animals and dry out the plant.)



■ Do not clean the product with gasoline or other volatile mixture solvents, and avoid contacting with spray insecticides.

(Otherwise, the product may crack or short circuit with the possibility of injury, fire or electric shock.)

■ Do not operate this product in places where indoor fumigation type insecticides are being used.

(Chemical residue may build up inside the product and discharge from the air outlet, and cause damage to health.)

- Ventilate the room with fresh air thoroughly after using insecticides before operating the product.

■ Do not sit on or lean against this product.

(Otherwise, the product may fall over and injury may occur or damage the product.)

- Families with children should pay more attention.

CAUTION



- Do not place the product near combustible materials such as lighted cigarette, incense, etc. (Otherwise, these may be absorbed into the product with possibility of fire.)



- When carrying the product, please hold the left and right handles, but not the front panel. (Otherwise, the product may fall off, injury may occur.)

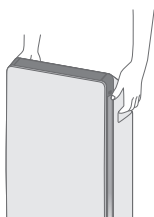

- When disconnecting the power plug, hold the power plug instead of the power cord. (Otherwise, the power cord may be damaged with the possibility of fire or electric shock.)
- Keep the room well-ventilated when using the product together with a burner. (Otherwise, carbon monoxide poisoning may occur.)
 - This product cannot remove carbon monoxide.

SETTING AND OPERATING REQUIREMENTS

Area that can enhance the effectiveness!

- Way to against PM2.5 and indoor dust, etc.

We recommend you to place the product on flat floor in the room.

- Way to circulate air more effectively.

Place the product with its left, right and top about 30 cm or more away from walls, furniture or curtains, etc. Otherwise, the pollutants are difficult to be cleared.

To ensure effectiveness of this product, keep its back at least 1 cm away from the wall.



- If the product is used in the same place for a long period.

It may result in dirty surrounding walls or floor. We recommend that you move the product away from where it is placed when maintaining it.

- Do not use the same power socket with TV, radio, etc.

(Otherwise, visual disturbances or noises may be caused.)

→ In this case, insert the power plug into another power socket.

- Do not place obstacles on the product air inlet and outlet.

(Otherwise it may affect product performance.)

- Do not set the product in the following places.

- Where the product will be exposed directly to sunlight, outlet of air conditioner or heat, etc. (Otherwise, deformation, degeneration, discolor or malfunction may be occurred.)

- Near equipment such as TV and radio. (Otherwise, visual disturbances or noises may be caused.)

→ Keep the product 1 m or above away from such devices.

- Do not place any object on the product.

(Otherwise, an operation error or malfunction may be caused.)

PRODUCT FEATURES

“House Dust Catcher” and “nanoe™ X” give you clean and fresh air.

- House Dust Catcher completely cleaning dust from the air near the floor
- Equipped with nanoe™ X technology
- Compact and stylish design

■ About nanoe™ X

- The so-called nanoe™ X are charged water purification particles generated by applying high voltage to separate water molecules.
- nanoe™ X features: high moisture content, small particles, high stability, etc.

1. High moisture content (the moisture content is 1,000 times the moisture content of ordinary anions).
2. Small particles (about 5 nm - 20 nm (nanometers) in size, able to penetrate deep into the fiber and stratum corneum).
3. High stability (6 times more stable than a common ion, covering a distance of 10 m or above).
4. More hydroxyl radicals (up to 4,800 billion of radicals are generated per second).
5. Weak acidity (with weak acidity features close to that of hair and skin).



All of the above features have been tested by SGS-CSTC Standards Technical Services Co., Ltd.

Note: nanoe™ and the nanoe™ mark are trademarks of Panasonic Holdings Corporation. nanoe™ X are particulate ions containing hydroxyl radicals whose amount is 10 times that of nanoe™.

CONFIRMATION AND SETUP

MAIN PARTS IDENTIFICATION

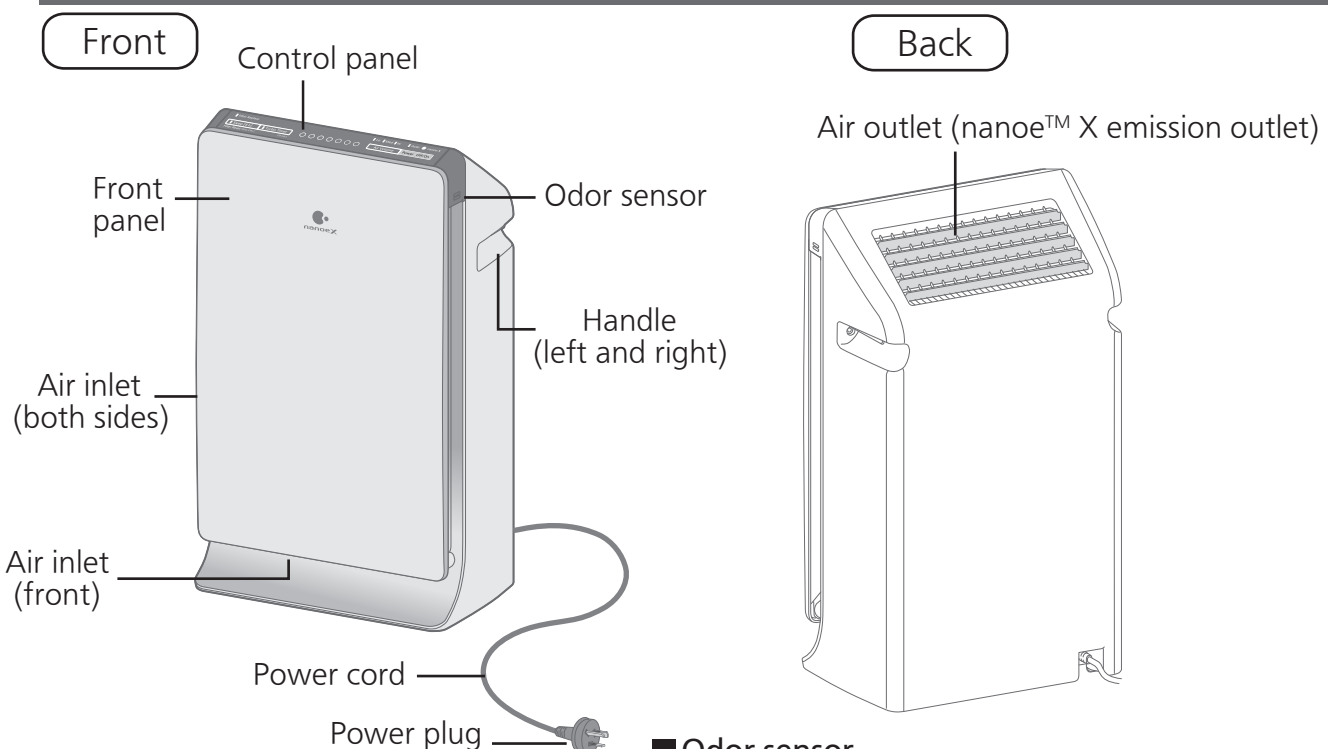

■ Odor sensor

Odor sensor can detect odor such as smoke, etc. The sensitivity of sensor can be adjusted. (P.10)

MAIN PARTS IDENTIFICATION

Control panel

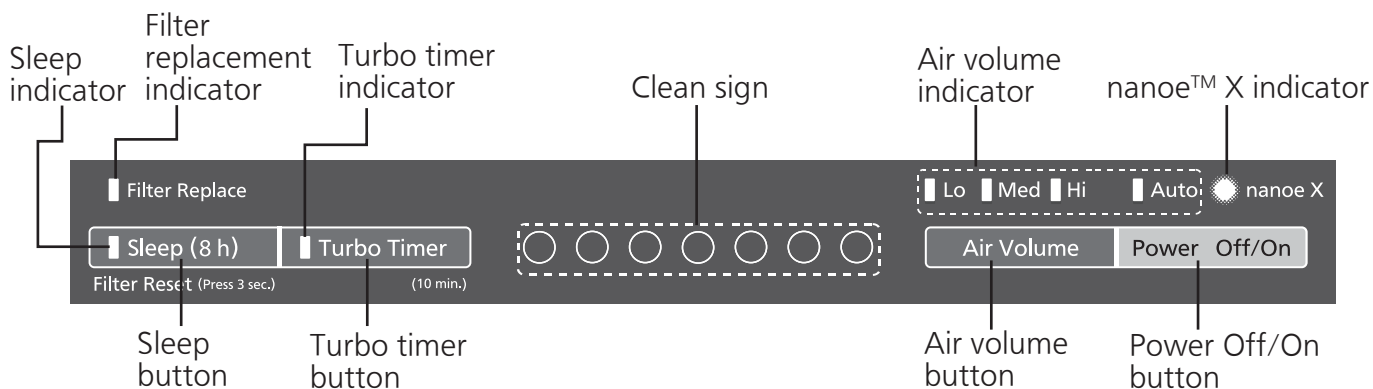

nanoe™ X indicator

The indicator lights on indicates nanoe™ X is being generated. nanoe™ X will be generated in all operation modes except you switch off it. (P.10)

Clean sign

Show the air pollution levels detected by odor sensor. The clean sign can be turned off. (P.11)

- Indicates clean
- Indicates slight dirty
- Indicates dirty

SETUP

Before startup

1

Fill in the label with the first date of use.

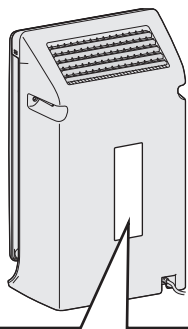

<p>■ HEPA composite filter replacement (About once every 3 years)</p> <p>Replacement filter Part No. F-ZXMP35Z</p> <p>Date installed:</p>
<p>■ Deodorizing filter replacement</p> <ul style="list-style-type: none"> • Replace a new one when the deodorizing function becomes less effective. (About once every 3 years) <p>Replacement filter Part No. F-ZXFD35X</p> <p>Date installed:</p>

Notice

Make sure to read page 2~4 before setting up the product.

Install filters

2

Remove the deodorizing filter from the poly bag.

① Remove the front panel.

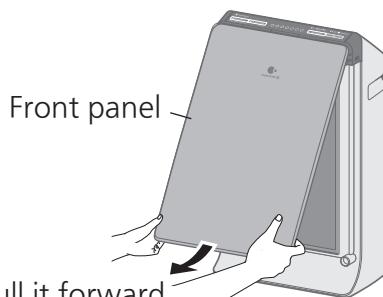

Pull it forward with both hands

② Remove the filters (2 types).

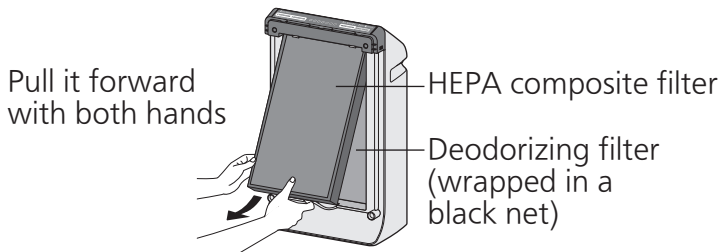

Pull it forward with both hands

③ Remove the deodorizing filter from the poly bag.

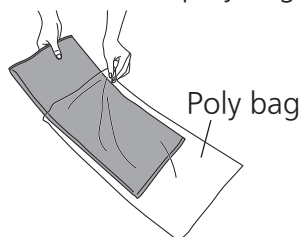

Notice

Please don't remove the black net of deodorizing filter.

SETUP

Install filters

3 Install the filters (2 types) and front panel.

① Install deodorizing filter.
(There is no distinction between inside and outside, upper and lower)

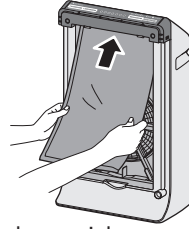

② Install HEPA composite filter.
(There is distinction between inside and outside, no distinction between upper and lower)

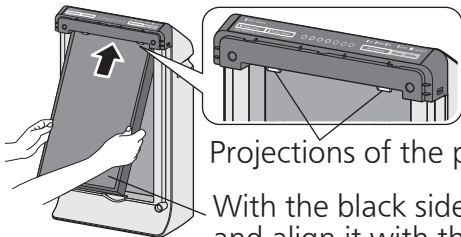

Projections of the product (2 places)

With the black side (front side) outside, and align it with the projections of the product.

③ Install front panel.

Fit the clutch into the indentation (3 places) of the product.

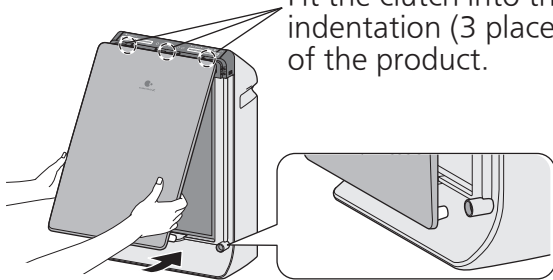

Push in the protrusion into holes (2 places) of product and press properly.

Notice

Be sure to install front panel before use.

Power-on

4 Connect the power plug.

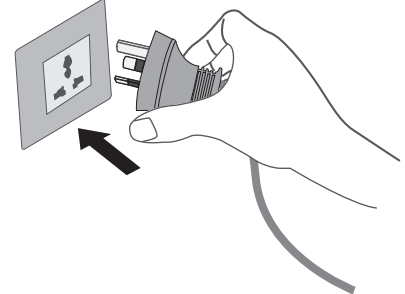

■ When inserting the power plug, as the odor sensor uses the degree of cleanliness at this time as the standard, we recommend that you plug it in when the air is fresh (such as when there is no cigarette smoke). (The standard of the odor sensor automatically updates itself according to the degree of the indoor cleanliness.)

■ Press **Power Off/On** button, then the clean sign blinks for about 5 seconds.

CONFIRMATION
AND SETUP

OPERATION

OPERATION



Sleep button Turbo timer button

Air volume button Power Off/On button

Power Off/On

Power Off/On



Turn on or off the product.

Press the button to operate. (Air volume indicator lights on)

1. When using for the first time, operation will begin with the air volume under "Auto".
2. Other than the above situations, operation will begin with the air volume from the last time it was stopped.
3. Press the button again, the product stops operating.

■ To operate product within 2 minutes after the power plug is inserted, the indicator of air volume under "Auto" will blink about 2 minutes, what it indicates the odor sensor is in the standby mode.

OPERATION

Air volume



Select appropriate air volume for purifying air.

The indicator will be changed sequentially as figure below.



Auto Automatically adjust the air volume according to the air pollution detected by sensor, and use appropriate air volume to purify air.

Lo Purify air quietly in low speed.

Med Purify air in medium speed.

Hi Purify air quickly.

(Indicator lights on)

Turbo Timer

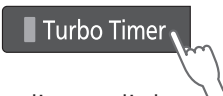

Turbo operation.

Press this button to begin turbo operation.

(Indicator lights on)

- During turbo operation, the clean sign will flash in blue and red. After 10 minutes, the turbo operation ends and will return to the previous operation mode.

- Press the button again to deactivate turbo operation. (The indicator turns off.)

Sleep

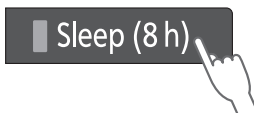

Sleeping operation.

When this button is pressed, the clean sign will turn off and operate with low air volume.

After 8 hours, the sleeping operation ends and the product stops operating.

(Indicator lights on)

- Press the button again to deactivate sleeping operation. (The indicator turns off.)

Notice

- If power failure occurs when product is operating, the product will restart automatically when power on again, and operate in the mode when power failure.

MAINTENANCE

WARNING



Make sure to disconnect the power plug before cleaning the product.

(Otherwise, the product might operate with the possibility of electric shock or injury.)

Notice

- For installation and removal methods of front panel and filters, please read P.6~7.
- When cleaning, do not leave the removed parts unattended. (Otherwise, it may cause tripping or damage.)
- Do not operate the product when the deodorizing filter is removed. (The deodorizing filter cannot function while it is removed.)
- When using chemically treated cloth, be sure to follow the instructions carefully.

- Do not operate the product when the HEPA composite filter is removed. (Dust will be inhaled into product inner parts, and causes the product breakdown. The HEPA composite filter cannot function while it is removed.)
- Do not use the detergents shown below.



MAINTENANCE

Cleaning method

HEPA composite filter < about once every 2 weeks >

Clean the black side (front side) with a vacuum cleaner, etc.

- Please do not punch too much, otherwise the filter may be damaged.
- Maintenance is unnecessary for the white side (back side).
- Do not wash the filter with water.

Dusting brush nozzle
or gap suction nozzle

Lay with newspapers, etc
to avoid dust messing floor.

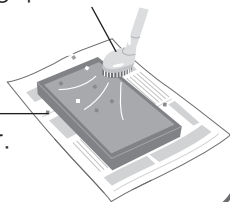

Deodorizing filter

- When there is dust around the deodorizing filter, remove the dust with a vacuum cleaner, etc.
- Do not wash the filter with water.

Body and front panel < about once a month >

Wipe off any dust and dirt using a well wrung-out cloth

- Do not wipe it with a hard cloth or hardly. Otherwise, the surface may be damaged.
- Wipe the power plug with a dry cloth.

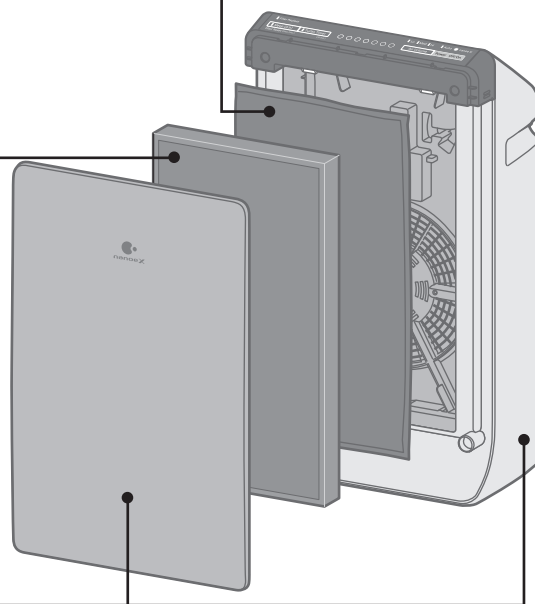

Filter replacement

	HEPA composite filter	Deodorizing filter
Replacement period	When the filter replacement indicator lights on. (About once every 3 years)*	
Conditions	When the product inhales the smoke of six cigarettes every day. (Japan Electrical Manufacturers' Association JEM1467)	

(Optional accessories: back cover)

※ Filter replacement period may be shorten, depending on the environment (such as where smoking is frequent). Please replace it when ineffective.

- ① After replacement, please connect power plug, then press **Sleep (8 h)** button for about 3 seconds until the filter replacement indicator turns off, then the reset is completed.
- ② Fill in installation date on the label attached with filter, then stick it on product to cover the old date. (P.6)

Notice

- The filter which needs to exchange cannot be used again even it is cleaned, please dispose the used filter as non-flammable garbage.
- If the product is used in a room (especially hotel) with strong odor such as aromatic smell, cigarette smoke or barbecue smell, these odors may adhere to the filter. When the adsorption capacity of filter reaches saturation, odor will also be blown out again with the wind because of excess adsorption. When there is above situation, please clean the HEPA composite filter. If the situation persists, please replace the HEPA composite filter and deodorizing filter, even if the filter replacement indicator is off. In addition, if often used in a room with strong odor, please open the windows to ventilate the room regularly.

MAINTENANCE

When idle for a long time

- ① Disconnect power after turning off the product. (The product still consumes power even at rest.)
- ② Maintain the product as usual.
- ③ Put the product into poly bag and carton, and keep it in a dry place. (If you overturn it or keep it flat, product malfunctions may occur.)

FURTHER INFORMATION

About nanoe™ X

- nanoe™ X can be switched off.
During operation, press **Turbo Timer** and **Sleep (8 h)** buttons at the same time for about 3 seconds (nanoe™ X indicator lights off). Press the buttons for about 3 seconds again to restart the nanoe™ X. (nanoe™ X cannot be set during product stops operating.)
- Conditions for nanoe™ X generation
nanoe™ X is generated by using the air in the room. Therefore, due to the differences in temperature and humidity nanoe™ X may not be generated stably.
 - Room temperature: about 5 °C~35 °C (dew-point temperature: 2 °C or above)
 - Relative humidity: about 30%~85%
- When nanoe™ X is generated, small amount of ozone will be released. However, the quantity will be far less than the level in natural environment such as forest, and not be harmful to human beings.

About HEPA composite filter

The HEPA composite filter which with the Bio-sterilization and Super Allergy-buster can inhibit allergens (pollen, dead mites and feces), bacteria, mold.

- Super Allergy-buster: inhibits the activity of allergic substances (pollen, dead mites and feces).
Testing authority: Osaka Municipal Technical Research Institute
Test method: check the decrease of refined house dust mite allergen, by using enzyme immune measuring method.
Inhibiting method: contact with Super Allergy-buster
Target: allergens trapped by the filter (mites, pollen)
Test result: inhibited 99% and above. (Daikou research report No. 2127)
- The HEPA composite filter might emit unique and harmless smell of "Green Tea Catechin", "Bio-sterilization" and "Super Allergy-buster".

About odor sensor

The sensor can detect the pollution of the air, and show the pollution level by indicator. The product can optimize the air volume automatically in auto operation according to the air quality.

Sensor	Sensing scope	May detect
Odor sensor	<ul style="list-style-type: none">• Odor from cigarettes, incense, cooking, pets• Cosmetics, alcohol, sprays, etc.	<ul style="list-style-type: none">• Humidity (water vapor), oil• The wind generated when a door is opened or closed, or sudden temperature changes

- The sensor's operation may vary depending on the indoor airflow condition if a heater is placed near the product in a room.
 - The sensor is not designed to detect bacteria and viruses.
 - The sensitivity of the sensor can be adjusted. (The default setting is "medium sensitivity" .)
- ① Stop operating the product, then press **Turbo Timer** and **Air Volume** buttons at the same time for about 3 seconds. The air volume indicator will light on sequentially.



- ② Please release the buttons, when the sensitivity is set as required.

FAQ

Please confirm the following before you put questions forward or send the product for repair.

- Q1 Why is a “jee” sound from the emission outlet?**
A There is a slight sound when nanoe™ X is being generated. Depends on the environment and operation mode, the sound may be a bit loud or inaudible but it is not abnormal.
- Q2 Why does the clean sign remain red even when the operation continues?**
A The indicator may illuminate red when the product is subject to steam or vapor emitting from sprayers.
- Q3 Why does the clean sign remain blue even when the air is dirty?**
A Is the product placed in area where the dirty air is difficult to be cleared or the room size is too large for the product? (P. 4, back cover)
- Q4 How to turn off the clean sign?**
A ■ Please press **Sleep (8 h)** and **Air Volume** buttons at the same time for about 3 seconds during operation.
 ■ Please press the buttons for about 3 seconds again to relight clean sign.

TROUBLESHOOTING

If a problem is encountered, please investigate it by going through the following items. If the problem still persists, please disconnect the power plug and contact the dealer for repair.

Possible situation	Please confirm the following
① Polluted air is difficult to be removed	■ Is the HEPA composite filter dirty? (P.9) → Please clean it. If the situation persists, replace the filter with a new one.
② The air volume is small	
③ The odor from the product is unpleasant	■ Is the body, front panel or filter dirty? (P.9) → If the problem persists after the filter is cleaned, please replace it with a new one. (The harmful carbon monoxide generated by cigarette cannot be removed) ■ Has the product ever been used in a room with strong odor? If the product is used in a room with strong odor such as aromatic smell, cigarette smoke or barbecue smell, the filter replacement period may be shortened. → If you use the product in such environments, it is recommended to open the air ventilation system or open the windows to ventilate the room at the same time. If there is still strong odor to be blown out after the maintenance, please replace the HEPA composite filter and deodorizing filter, even if the filter replacement indicator does not light on.
④ The sensor sensitivity can not be set up	■ Is the product turned on? Sensor sensitivity can not be set up unless the product turned off.

If any of the following cases occur, please contact the dealer immediately for repair.

All the air volume indicators are blinking	■ Product may be out of order. → Please disconnect the power and contact the dealer for repair.
--	--

SPECIFICATIONS

Model number	F-PXV35M		
Power supply	220 V-240 V~ 50 Hz 220 V-230 V~ 60 Hz		
Air volume settings	Hi	Med	Lo
Power consumption (W) ^{※1}	24	9	6
Air volume (m ³ /min)	3.5	2.0	1.0
Floor area capacity ^{※2}	Up to 46 m ² in a standard household room		
Power cord length	2.0 m		
Product dimension	300 mm x 189 mm x 520 mm (WxDxH)		
Product weight	4.8 kg		

※1 The power consumption is about 0.8 W when the operation is set to "Off".
(With the power plug inserted).

※2 Floor area capacity is based on NRCC 54013, under the condition of high speed.

Note: This product cannot remove hazardous substances such as carbon monoxide from the cigarette smoke.

OPTIONAL ACCESSORIES

● Replacement HEPA composite filter

Part No.: F-ZXMP35Z



● Replacement deodorizing filter

Part No.: F-ZXFD35X



Please contact dealer

- All the air volume indicators are blinking.
Product may be out of order.
Please disconnect the power and contact the dealer for repair.
For additional help please contact the Panasonic Customer Care Centre on 13 26 00.

Panasonic Corporation

Web Site: <http://www.panasonic.com>

© Panasonic Corporation 2022

Issue date: 12/2022

发行日期: 12/2022

P1222-0 PXV3M8954