



Panasonic®

Operating Instructions
(Household use) Rechargeable Body Hair Trimmer

Model No. ER-GK80

Contents

Safety precautions	2	Troubleshooting	14
Important information	6	Blade life	15
Parts identification	7	Battery life	15
Preparation	7	Removing the built-in rechargeable battery	15
Read before use	8	Specifications	16
How to use	9		
Maintenance	12		

Thank you for purchasing this Panasonic product.



Before operating this unit, please read these instructions completely and save them for future use.

Safety precautions



To reduce the risk of injury, loss of life, electric shock, fire, and damage to property, always observe the following safety precautions.

Explanation of symbols

The following symbols are used to classify and describe the level of hazard, injury, and property damage caused when the denotation is disregarded and improper use is performed.

 DANGER	Denotes a potential hazard that will result in serious injury or death.
 WARNING	Denotes a potential hazard that could result in serious injury or death.
 CAUTION	Denotes a hazard that could result in minor injury or property damage.

The following symbols are used to classify and describe the type of instructions to be observed.

	This symbol is used to alert users to a specific operating procedure that must not be performed.
	This symbol is used to alert users to a specific operating procedure that must be followed in order to operate the unit safely.

WARNING

► This product

This product has a built-in rechargeable battery. Do not throw into flame or heat.

-  - Doing so may cause fluid leak, overheating, or explosion.

Do not modify or repair.

-  - Doing so may cause fire, electric shock, or injury.
Contact an authorized service centre for repair (battery change, etc.).

 **Never disassemble except when disposing of the product.**

- Doing so may cause fire, electric shock, or injury.

► **In case of an abnormality or malfunction Immediately stop using and remove the adaptor if there is an abnormality or malfunction.**

- Failure to do so may cause fire, electric shock, or injury.

<Abnormality or malfunction cases>

-  • **The main body or AC adaptor is deformed or abnormally hot.**
 - **The main body or AC adaptor smells of burning.**
 - **There is abnormal sound during use or charging of the main body or AC adaptor.**
- Immediately request inspection or repair at an authorized service centre.



WARNING

► Power supply



Do not connect or disconnect the adaptor to a household outlet with a wet hand.

- Doing so may cause electric shock or injury.

Do not immerse the AC adaptor in water or wash with water.

Do not place the AC adaptor over or near water filled sink or bathtub.

Never use the appliance if the AC adaptor is damaged or if the power plug fits loosely in a household outlet.



Do not damage or modify, or forcefully bend, pull, or twist the cord.

Also, do not place anything heavy on or pinch the cord.

- Doing so may cause electric shock or fire due to a short circuit.

Do not use in a way exceeding the rating of the household outlet or the wiring.



- Exceeding the rating by connecting too many plugs to one household outlet may cause fire due to overheating.

Do not use anything other than the supplied AC adaptor for any purpose.



Also, do not use any other product with the supplied AC adaptor. (See page 7.)

- Doing so may cause burns or fire due to a short circuit.



Always ensure the appliance is operated on an electric power source matched to the rated voltage indicated on the AC adaptor.

Fully insert the adaptor.

- Failure to do so may cause fire or electric shock.



Always unplug the adaptor from a household outlet when cleaning.

- Failure to do so may cause electric shock or injury.



Regularly clean the power plug and the appliance plug to prevent dust from accumulating.

- Failure to do so may cause fire due to insulation failure caused by humidity.

- Disconnect the adaptor and wipe with a dry cloth.

► Preventing accidents



Do not store within the reach of children or infants. Do not let them use it.

- Putting parts or accessories in the mouth may cause an accident or injury.



If the oil is consumed accidentally, do not induce vomiting, drink a large amount of water, and contact a physician.

If the oil comes into contact with eyes, immediately wash thoroughly with running water, and contact a physician.

- Failure to do so may result in physical problems.

WARNING

This appliance is not intended for use by persons (including children) with reduced physical, sensory or mental capabilities, or lack of experience and knowledge, unless they have been given supervision or instruction concerning use of the appliance by a person responsible for their safety. Children should be supervised to ensure that they do not play with the appliance.
- Failure to do so may cause an accident or injury.

 **The supply cord cannot be replaced. If the cord is damaged, the AC adaptor should be scrapped.**
- Failure to do so may cause an accident or injury.

CAUTION

► **Protecting the skin**

Do not press the blade strongly on the skin. Do not use this product for any purpose other than trimming body hair.

Do not use this product without an attachment to trim hair in the following areas: sensitive zones, buttocks, anus, and surrounding areas.

 **Do not use this product to trim hair in the following areas.**

- Face or head (hair, beard, etc.)
 - Areas with rough or bumpy skin (swollen areas, cuts, hemorrhoids, and other protuberances; nipples and surrounding areas)
 - Moles, bruises, etc.
- Doing so may cause skin injury.

Do not forcefully press the blade. Also, do not touch blade with nails.

 **Do not bring the blade into contact with hard objects.**

- Doing so may cause the blade to become damaged and injure the skin as the blade is very thin. Be careful when using it.

 **Check that the blades are not damaged or deformed before use.**

- Failure to do so may cause skin injury.



CAUTION

► **Note the following precautions**

Do not allow metal objects or trash to adhere to the power plug or the appliance plug.



- Doing so may cause electric shock or fire due to a short circuit.

Do not share your appliance with your family or other people.



- Doing so may result in infection or inflammation.

Do not drop or hit against other objects.



- Doing so may cause injury.

Do not wrap the cord around the adaptor and main body when storing.



- Doing so may cause the wire in the cord to break with the load, and may cause fire due to short circuit.

Disconnect the adaptor from the household outlet when not charging.



- Failure to do so may cause electric shock or fire due to electrical leakage resulting from insulation deterioration.

Disconnect the adaptor or the appliance plug by holding onto the adaptor or the appliance plug instead of the cord.



- Failure to do so may cause electric shock or injury.

Handling of the removed battery when disposing



DANGER

The rechargeable battery is exclusively for use with this appliance. Do not use the battery with other products.

Do not charge the battery after it has been removed from the product.

Do not throw into fire or apply heat.

Do not solder, disassemble, or modify the battery.



Do not let the positive and negative terminals of the battery get in contact with each other through metallic objects.

Do not carry or store the battery together with metallic jewellery such as necklaces and hairpins.

Never peel off the tube.

- Doing so may cause fluid leak, overheating, or explosion.

The battery contains alkaline fluid. If it comes in contact with the eyes, do not rub the eyes, and thoroughly rinse with clean water, such as tap water.



- Failure to do so may cause loss of vision.

- Consult a physician immediately.



WARNING

After removing the rechargeable battery, do not keep it within reach of children and infants.



- The battery will harm the body if accidentally swallowed.
- If this happens, consult a physician immediately.

The battery contains alkaline fluid. If it comes in contact with the skin or clothes, rinse off with clean water, such as tap water.



- Failure to do so may cause skin injury.

Important information

- This WET/DRY appliance can be used for wet trimming or for dry trimming. You can use this watertight appliance in the shower and clean it in water. The following symbol means suitable for use in a bath or shower.



- Before using an attachment, check that it has been installed correctly. Failure to do so may cause hair to be cut too short.
- The appliance should not be used on animals.

- Apply the oil to the blade before and after each use. (See page 14.)

Failure to apply the oil may cause the following problems.

- The blade has become blunt.
- Shorter operating time.
- Louder sound.
- Store the main body in a place with low humidity after use. Failure to do so may cause malfunction due to condensation or rust.
- Charge the appliance correctly according to these Operating Instructions. (See page 7 “Charging”.)
- This appliance contains battery that is only replaceable by skilled persons. Please contact an authorized service centre for the details of repair.
- The following symbol indicates that a specific detachable power supply unit is required for connecting the electrical appliance to the supply mains. The type reference of power supply unit is marked near the symbol.



- Be sure to place the skinguard attachment on the main body to protect blade when carrying around or storing.

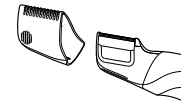

Parts identification

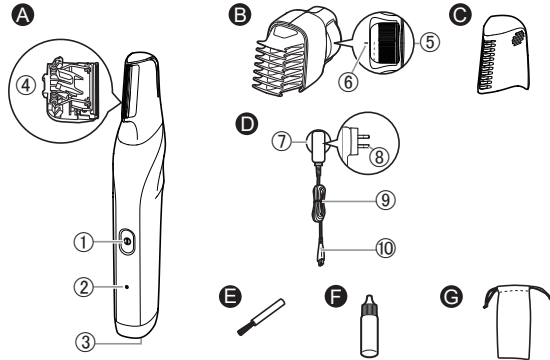

A Main body

- ① Power switch
- ② Charge status lamp (→)
- ③ Appliance socket
- ④ Blade

B Trimming height comb attachment

- ⑤ Dial
- ⑥ Trimming height indication mark

C Skinguard attachment

D AC adaptor (RE9-86)

- The shape of the AC adaptor differs depending on the area.
- One of the power supply units specified is provided with this appliance.

- ⑦ Adaptor
- ⑧ Power plug
- ⑨ Cord
- ⑩ Appliance plug

Accessories

- E Cleaning brush
- F Oil
- G Pouch

Preparation

Charging

- Make sure that the main body is turned off.

1 Connect the appliance plug to the appliance socket.

2 Plug in the adaptor into a household outlet.

- Check that the charge status lamp (→) glows.
- Charging is completed after approx. 1 hour.

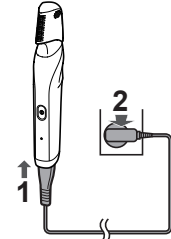

3 Disconnect the adaptor when the charge status lamp stops glowing.

(for safety and to reduce energy usage)

<How to check if the charging is completed>

Remove and reinsert the appliance plug. If the charge status lamp glows and turns off after approximately 5 seconds, it is completed.

You cannot operate the trimmer while charging.

Notes







- If there is noise from the radio or other sources while using or charging the appliance, move to a different location to use the appliance.

- When the appliance is not used for 6 months or more, the battery will weaken (leak battery fluid, etc.). Fully charge the battery once every 6 months.
- When the appliance is charged for the first time or it has not been in use for more than 6 months, the charging time may change or the charge status lamp may not glow in the first few minutes. In addition, the operating time may become shorter. Please charge it for more than 8 hours in such cases.
- Recommended ambient temperature for charging is 0 °C – 35 °C. The charging time may change or battery performance may decrease outside of the recommended temperature.
- A full charge supplies enough power for approximately 50 minutes of use. (Based on using at 20 °C – 30 °C.) The operating time may differ depending on the frequency of use and the operating method.
- You can charge the battery before it is completely discharged. However, it is recommended to charge when the battery is completely discharged. The battery life depends strongly on factors such as how it is used and stored.

Read before use

Areas of use

✓ OK ✗ Do not use

Area	When used with an attachment	When used without an attachment
Sensitive zones • Genitalia • Genital area • Crotch 	✓	✗
• Buttocks • Anus • Perianal region 	✓	✗
Armpits 	✓	✓
Chest 	✓	✓
Navel area 	✓	✓
Arms, hands 	✓	✓
Legs 	✓	✓

- Using this appliance to trim hair in areas that are not visually accessible may result in cuts or injury. Please use with care.

- Using this main body to trim hair in the shaded areas () below may result in cuts or injury. Be sure to use an attachment.

Sensitive zones



Buttocks



Notes

- Stretch the skin on the areas with loose or flabby skin, or with wrinkles, and lightly apply the edge of the blade or attachment.
- Do not use the attachment on wet hair. Wet hair might clump or stick to the skin, becoming hard to trim. If you use the attachment to trim wet hair, you may not be able to achieve a uniform trim.
- For areas with thick or dense hair growth, trim a bit at a time. Hair sometimes gets caught or builds up in the attachment. When this happens, clean the attachment. (See pages 12 and 13.)

How to use

- Apply the oil to the blade before and after each use. (See page 14.)
- The appliance may not operate in an ambient temperature lower than approximately 0 °C.
- Please clean the appliance after each use. (See pages 12 and 13.)

<Note before trimming>

- Make sure that the main body is turned off.
- Check that the blades are not damaged or deformed before use.

Trimming dry hair

- 1 Select the desired attachments, then press the power switch to turn on the power and trim.**
 - Use the appropriate attachment as needed. It can also be used without the attachment.
 - Without the attachment (See page 11.)
 - Skinguard attachment (See page 11.)
 - Trimming height comb attachment (See page 11.)
- 2 Turn off the switch after use.**

Trimming wet hair

- Do not use the attachment when trimming wet hair.

- 1 Wet and apply soap to your body.**
- 2 Press the power switch to turn on the power and trim.**
 - Without the attachment (See page 11.)
- 3 Apply less pressure than you would when trimming dry hair, and move the main body in a gliding motion.**
- 4 Turn off the switch after use.**



Removing and mounting the attachments

- Take care not to injure hands, etc., with the blade when removing or mounting the attachment.

► Removing the attachment

Hold the main body securely and pull the attachment out upward and remove it from the main body.

- Hold the rib (a) part securely and remove the skinguard attachment.

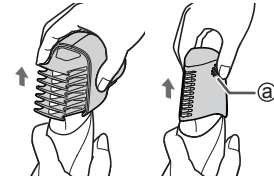

► Mounting the attachment

Mount the attachment to the main body until it clicks.

- If the attachment is not attached correctly, it may shift and end up cutting too much during use.

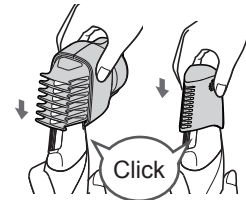

Without attachment



Apply light pressure and slowly move the main body against the direction of hair growth.



- To trim navel hair, lay the blade flat against your skin and then move the main body in a gliding motion. This allows you to trim hair down to a length of approximately 0.1 mm.
- It does not matter which side of the blade you lay against your skin.

Skinguard attachment



Lightly apply the edge of the skinguard attachment against your skin and then slowly move the main body.

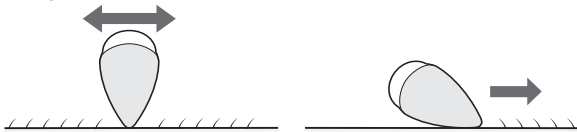

- This allows you to safely trim hair down to a length of approximately 2 mm.

Trimming height comb attachment



- The digit on the attachment indicates the target trimming length.
- Actual hair length will be a little longer than the height you set.
- The desired results may not be achieved if hair is too long. In this case, trim the hair to a length of about 20 mm before using the appliance.
- Hair will be easy to accumulate in the attachment when a lot of hair is cut. When this happens, clean the attachment. (See pages 12 and 13.)

1 Turn the dial and adjust the trimming height indication mark (b) to the desired height.

- Trimming height:
approx. 3 mm to 12 mm

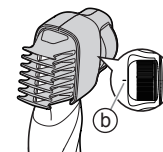

2 Apply the flat part of the comb against your skin and cut your hair by combing it left and right.

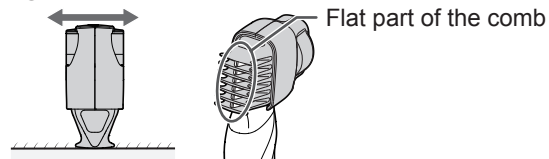

Maintenance

Cleaning

- Clean the main body and the blade after each use. (If not cleaned, the motion will become poor and the sharpness will worsen.)
- Do not use thinner, benzine, alcohol or other chemicals. Doing so may cause failure, cracking or discoloration of the main body. Wipe the main body only with a soft cloth slightly dampened with tap water or soapy tap water.
- Make sure that the main body is turned off.
- Remove the main body from the AC adaptor.

► With water

To remove light dirt

1. Remove the attachment and turn the main body on. (See page 10.)
2. Run water down the water inlet at the back of the main body, rinse thoroughly for approximately 20 seconds, and then turn the main body off.

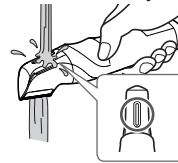

To remove heavy dirt

1. Remove the attachment and blade. (See pages 10 and 13.)
2. Clean the main body, the blade and the attachments with running water.

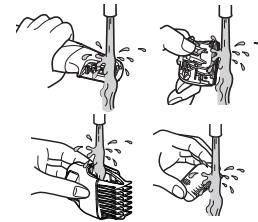

- Shake up and down several times to remove the water.
- Be careful not to hit the main body on the sink or any other object while draining the water. Failure to do so may cause malfunction.

3. Wipe off the water with a towel and let it dry naturally.

- It will dry faster with the blade removed.

4. Apply the oil to the blade after drying. (See page 14.)

5. Attach the blade and the skinguard attachment to the main body.

- Be sure to place the skinguard attachment on the main body to protect blade when storing.

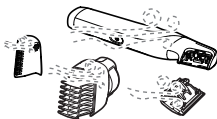

► With the brush

1. Remove the attachment and blade.

(See pages 10 and 13.)

2. Clean the main body using the brush.

3. Clean the blade using the brush.

- Keep pressing down the cleaning lever (c) to raise the moving blade (d) when cleaning between the stationary blade (e) and the moving blade.

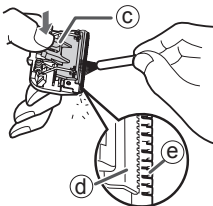

4. Apply the oil to the blade. (See page 14.)

5. Attach the blade and the skinguard attachment to the main body.

- Be sure to place the skinguard attachment on the main body to protect blade when storing.

Removing and mounting the blade

- Please check if the blade is deformed or damaged before removing and mounting it.

► Removing the blade

1. Hold the main body in front.

2. Push the metal part of the blade to the left with the thumb's belly.

- It is no problem when touch the blade by fingers.
- Be careful not to let the blade fall.

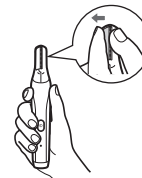

► Mounting the blade

Fit the mounting hook (B) into the blade mounting (A) on the main body and then push in until you hear a click.

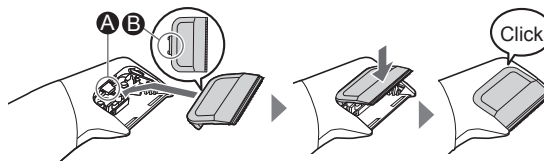

Lubrication

- Apply the oil to the blade before and after each use.

- 1 Remove the blade.**
(See page 13.)
- 2 Apply a drop of the oil to each indicated point.**
- 3 Attach the blade to the main body, turn on the power and allow to run for approximately 5 seconds.**

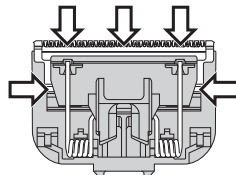

► Replacement parts

Replacement part is available at your dealer or Service Centre.

Replacement parts for ER-GK80	Blade	WER9500
-------------------------------	-------	---------

- Do not use any blade other than the one dedicated as it may cause defect in performance.

Troubleshooting

Perform the following actions.

If the problems still cannot be solved, contact the store where you purchased the unit or a service centre authorized by Panasonic for repair.

Problem	Action
The main body has become blunt.	<p>Until problems are solved, please follow each procedure as follows:</p> <ol style="list-style-type: none"> 1. Charge the main body. (See page 7.) 2. Clean the blade and apply oil. (See pages 12-14.) 3. Replace the blade. (See page 13.) 4. Have the battery replaced by an authorized service centre.
Operating time is short.	<p>Charge the battery for approximately 8 hours continuously to rejuvenate it.</p>
Main body stopped functioning.	<p>If few uses remain even after charging, the battery has reached the end of its life. (Fluid may be leaking due to degradation at the end of battery life.)</p> <p>Contact an authorized service centre for repair.</p>

Problem	Action
The main body cannot be charged.	<ul style="list-style-type: none"> ▶ Insert the appliance plug into the main body firmly. ▶ Check the charge status lamp glows. (See page 7.)
Makes a loud sound.	<ul style="list-style-type: none"> ▶ Apply oil. (See page 14.) ▶ Confirm that the blade is properly attached.

Blade life

Blade life varies according to the frequency and period of use of the main body.

For example, the blade life is approximately 3 years when using the main body for 10 minutes four times a month. Replace the blades if cutting efficiency reduces substantially despite proper maintenance.

Battery life

Battery life will vary according to the frequency and length of use. If the battery is charged once a month, the service life will be approximately 3 years.

If the operating time is significantly shorter even after a full charge, the battery has reached the end of its life.

Removing the built-in rechargeable battery

Remove the built-in rechargeable battery before disposing of the main body.

The battery is to be disposed of safely.

Please make sure that the battery is disposed of at an officially designated location if there is one.

This figure must only be used when disposing of the main body, and must not be used to repair it. If you dismantle the main body yourself, it will no longer be waterproof, which may cause it to malfunction.

- Remove the main body from the AC adaptor.
- Press the power switch to turn on the power and then keep the power on until the battery is completely discharged.
- Perform steps ① to ⑧ and lift the battery, and then remove it.
- Take care not to short circuit the positive and negative terminals of the removed battery, and insulate the terminals by applying tape to them.

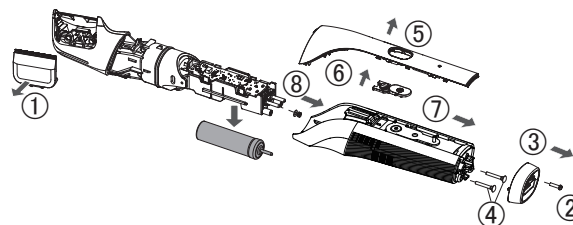

For environmental protection and recycling of materials

This main body contains a Nickel-Metal Hydride battery.
Please make sure that the battery is disposed of at an officially assigned location, if there is one in your country.

Specifications

Power source	See the name plate on the AC adaptor. (Automatic voltage conversion)
Motor voltage	1.2 V _{DC}
Charging time	Approx. 1 hour

This product is intended for household use only.

Panasonic Corporation
<http://www.panasonic.com>
© Panasonic Corporation 2021

Ⓔ EN

Printed in China
ER9700GK801541 Y0721-0