

# Panasonic

## LUMIX S9

Operating Instructions  
<Quick Start Guide>  
Digital Camera  
DC-S9

Please read these instructions carefully before using this product, and save this manual for future use.

### Operating Instructions <Complete Guide>



Refer to "Operating Instructions <Complete Guide>" (HTML format/PDF format) for details about how to use the camera and notes on use.  
<https://panasonic.jp/support/dsc/oi/S9/index.html>

Panasonic Entertainment & Communication Co., Ltd.  
Web Site: <http://www.panasonic.com>

© Panasonic Entertainment & Communication Co., Ltd. 2024

DVQX2534ZA  
F0424KN0

### Dear Customer,

We would like to take this opportunity to thank you for purchasing this Panasonic Digital Camera. Please read this document carefully and keep it handy for future reference. Please note that the actual controls and components, menu items, etc. of your Digital Camera may look somewhat different from those shown in the illustrations in this document.

## Information for Your Safety

### WARNING:

To reduce the risk of fire, electric shock or product damage,

- Do not expose this unit to rain, moisture, dripping or splashing.
- Use the recommended accessories.
- Do not remove covers.
- Do not repair this unit by yourself. Refer servicing to qualified service personnel.

### Product identification marking

Product	Location
Digital camera	Bottom

### About the battery pack

#### CAUTION

- Danger of explosion if battery is incorrectly replaced. Replace only with the type recommended by the manufacturer.
- When disposing of the batteries, please contact your local authorities or dealer and ask for the correct method of disposal.
- Do not heat or expose to flame.
- Do not leave the battery(ies) in a car exposed to direct sunlight for a long period of time with doors and windows closed.
- Do not expose to low air pressure at high altitudes.
- Do not expose to extremely low air pressure, as this may result in explosions or leakage of flammable liquids and gases.

#### Warning

Risk of fire, explosion and burns. Do not disassemble, heat above 60 °C or incinerate.

- Always use a genuine Panasonic Tripod Grip (DMW-SHGR2: optional).
- Use a Premium High Speed HDMI micro cable (Type D–Type A plug) with the length less than 3 m (9.8 feet).
- Use a stereo microphone cable with the length less than 3 m (9.8 feet).
- Keep the accessory shoe cover out of reach of children to prevent swallowing.
- Keep the memory card out of reach of children to prevent swallowing.

## Standard Accessories

Product numbers correct as of May 2024.

### Digital camera body

<b>Battery pack</b> DMW-BLK22	<b>Body cap<sup>*1</sup></b> 1HE1MC891Z
<b>Shoulder strap</b> DVPW1035Z	<b>Accessory shoe cover<sup>*1</sup></b> DVKV1118Z/K (Black) DVKV1118Z/H (Silver)

### Interchangeable lens "LUMIX S 20-60mm F3.5-5.6"<sup>\*2</sup> S-R2060

<b>Lens hood</b> 1ZE4SR2060Z	<b>Lens rear cap<sup>*3</sup></b> RGE1Z276Z
<b>Lens cap<sup>*3</sup></b> CGE1Z293Z	

- \*1 This is attached to the camera at the time of purchase.
- \*2 This is supplied with Lens Kit DC-S9K.
- \*3 This is attached to the lens at the time of purchase.

- Consult the dealer or Panasonic if you lose the supplied accessories. (You can purchase the accessories separately.)

## Names of Important Parts

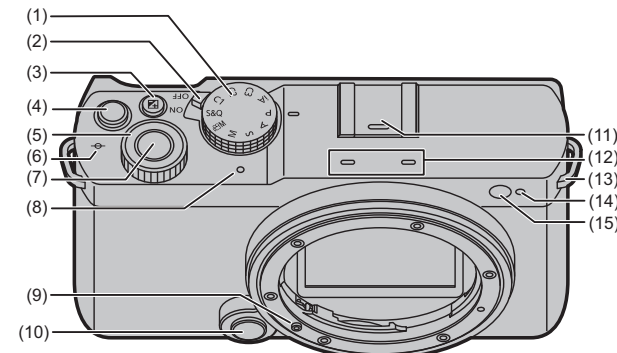

- |   |   |
|---|---|
| (1) Mode dial                               | (8) Charging light/Network connection light |
| (2) Camera on/off switch                    | (9) Lens lock pin (Lens fitting mark)       |
| (3) [ ] (Exposure compensation) button      | (10) Lens release button                    |
| (4) Video rec. button                       | (11) Accessory shoe (accessory shoe cover)  |
| (5) Front dial                              | (12) Stereo microphone                      |
| (6) [ ] (Recording distance reference mark) | (13) Shoulder strap eyelet                  |
| (7) Shutter button                          | (14) Self-timer light/AF assist light       |
|   | (15) Illumination sensor                    |

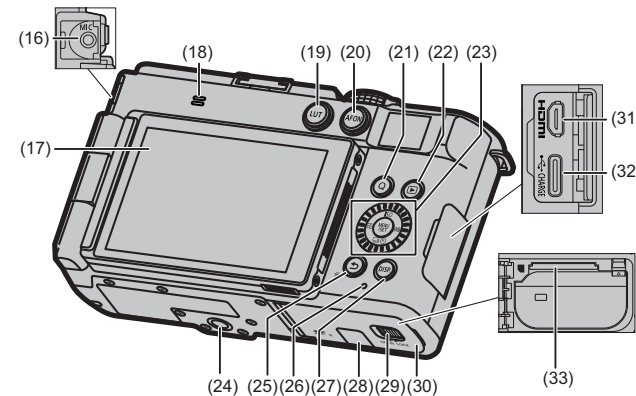

- |                              |  |
|------------------------------|--|
| (16) [MIC] socket            | (24) Tripod mount                                |
| (17) Monitor/Touch screen    | (25) [ ] (Cancel) button/<br>[ ] (Delete) button |
| (18) Speaker                 | (26) Card access light                           |
| (19) [LUT] button            | (27) [DISP.] button                              |
| (20) [AF ON] button          | (28) DC coupler cover                            |
| (21) [Q] (Quick menu) button | (29) Release lever                               |
| (22) [ ] (Playback) button   | (30) Card/Battery door                           |
| (23) Control dial ( )        | (31) HDMI socket                                 |
| Cursor buttons               | (32) USB port                                    |
| ▲/[ISO] (ISO sensitivity)    | (33) Card slot                                   |
| ▼/[ ] (Drive mode)           |  |
| ◀/[ ] (AF mode)              |  |
| ▶/[WB] (White balance)       |  |
| [MENU/SET] button ( )        |  |

## Attaching a Shoulder Strap

Attach a shoulder strap to the camera with the following procedure to prevent it from dropping.

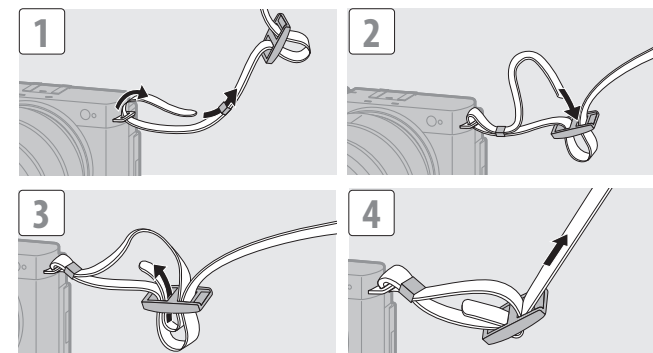

## Charging the Battery

Charge using an AC adaptor (optional/commercially available) and a USB connection cable (commercially available).

- Set the camera on/off switch to [OFF].
- Insert the battery into the camera.

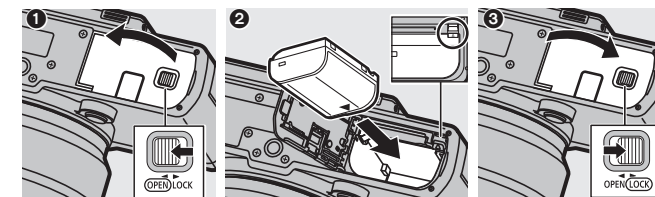

- Connect the camera USB port and the AC adaptor using the USB connection cable.
- Connect the AC adaptor to an electrical outlet.

- The charging light turns red and charging begins. The charging light turns off when charging is complete.

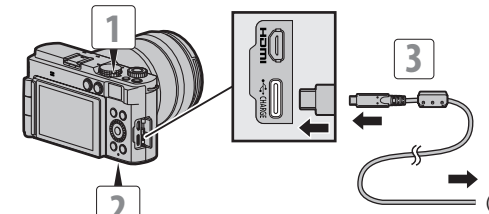

(A) To the AC adaptor

Charging time	Approx. 240 min
---------------	-----------------

- Using either the camera body and the optional AC Adaptor (DMW-AC11) or the camera body and the supplied accessories of the optional Battery Charger (DMW-BTC15).

### Cautions

- The battery that can be used with the camera is DMW-BLK22. (As of May 2024)
- Always use genuine Panasonic batteries (DMW-BLK22).**
- If you use other batteries, we cannot guarantee the quality of this product.**
- It is recommended to use the Panasonic AC Adaptor (DMW-AC11: optional) or the supplied accessories of the Panasonic Battery Charger (DMW-BTC15: optional) for charging.**
- You can charge with the camera body using a commercially available AC adaptor and a USB connection cable.
  - \*Recommended specifications for the commercially available AC adaptor
    - Supports 5 V/3 A (15 W) DC output
    - USB Type-C terminal
  - \*Use a USB connection cable with 15 W output or better for charging.
- You can also use an AC adaptor with 5 V/500 mA or better for charging. However, charging time may be longer than with the recommended AC adaptor.
- Operation is not guaranteed with all commercially available devices.
- Using charging methods other than those specified may result in fluid leakage, overheating, combustion, rupturing, etc., and these may cause injury.
- This battery may present a risk of fire or chemical burn if mistreated.
- Place the removed battery in a plastic bag, and store or keep away from metallic objects (clips, etc.).
- When disposing of the batteries, please contact your local authorities or dealer and ask for the correct method of disposal.

## Inserting Cards (Optional)

You can use SD memory cards with this camera.

- For information on memory cards with confirmed operation, check the following support site:  
<https://panasonic.jp/support/global/cs/dsc/connect/index.html>  
(English only)

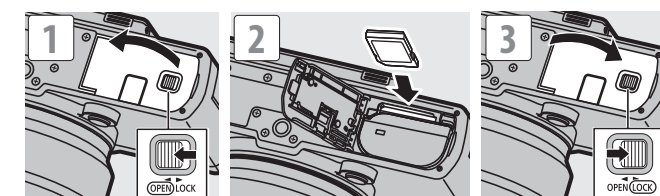

- Match the orientation of the cards as shown in the figure and then insert them firmly until they click.
- To remove a card, confirm that the corresponding card access light has turned off, push the card until it clicks, then pull the card out straight.
- Format the cards with the camera before use.  
[ ] → [ ] → Select [Card Format]

## Attaching a Lens

The lens mount of this camera is compliant with the L-Mount standard of Leica Camera AG.

- Refer to catalogs/websites for information regarding supported lenses.  
<https://panasonic.jp/support/global/cs/dsc/connect/index.html>  
(English only)
- Attaching commercially available accessories that do not comply with the L-Mount standard may lead to operation failure or malfunction of the camera.
- If a failure or malfunction occurs due to this cause, the warranty will be void.

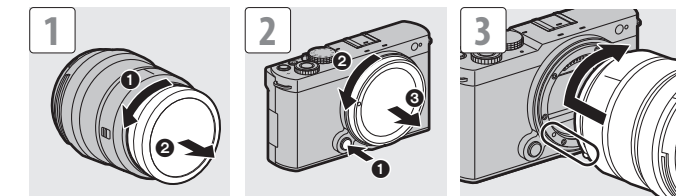

- When removing the lens or body cap, rotate while pressing the lens release button.

## Setting the Clock (When Turning On for the First Time)

When you turn the camera on for the first time, a screen to set the time zone and clock appears. Follow the message to make the settings.

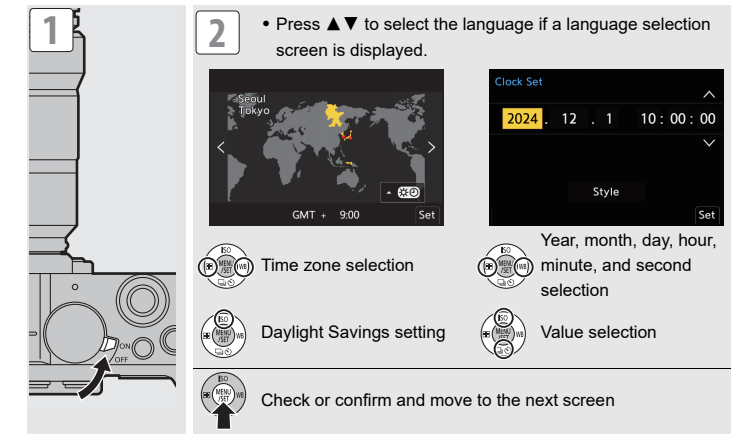

## Taking Pictures

- Rotate the mode dial to select the recording mode ([IA]/[P]/[A]/[S]/[M]).**
- Press the shutter button halfway (press it gently) to focus.**
- Press the shutter button fully (press it further) to take pictures.**

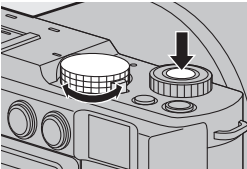

## Recording Videos

- Rotate the mode dial to select the recording mode.**
- Press the video rec. button to start recording.**
- Press the video rec. button again to end recording.**

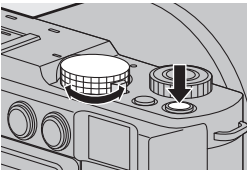

## Playing Back Images

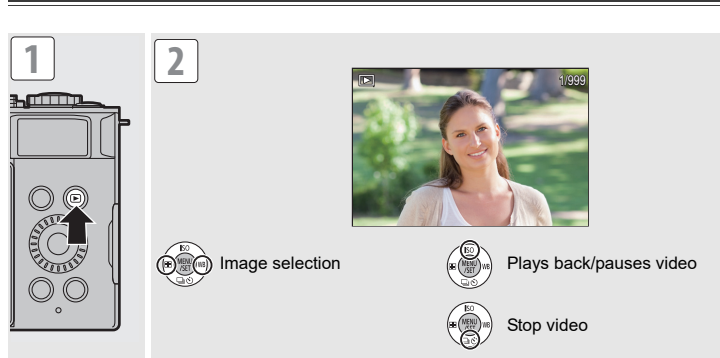

## Cautions for Use

### ❖ Firmware of Your Camera/Lens

Firmware updates may be provided in order to improve camera capabilities or to add functionality.

- For the latest information on the firmware or to download/update the firmware, visit the following support site: <https://panasonic.jp/support/global/cs/dsc/download/index4.html> (English only)



### ❖ Handling of the Camera

The camera is not dust resistant, splash resistant, or waterproof.

**Avoid using the camera in places with excessive dust or sand, or where water can come into contact with the camera.**

### ❖ Be Sure to Perform Trial Recording in Advance

Be sure to perform trial recording in advance to check that recording can be performed normally.

Please note that compensation cannot be provided in the event that recording could not be performed due to a problem with the camera or a card.

### ❖ Be Careful with Regard to Copyrights

Under copyright law, you may not use the images and audio you have recorded without the permission of the copyright holder.

### ❖ Caution with Strong Light Beams Such as Laser Light

Do not allow strong light beams, such as laser light, to be directly exposed to this camera (lens). These can destroy the image sensor and cause the camera to malfunction.

### ❖ The camera

**Keep this unit as far away as possible from electromagnetic equipment (such as microwave ovens, TVs, video games etc.).**

- If you use this unit on top of or near a TV, the pictures and/or sound on this unit may be disrupted by electromagnetic wave radiation.
- Do not use this unit near cell phones because doing so may result in noise adversely affecting the pictures and/or sound.
- Recorded data may be damaged, or pictures may be distorted, by strong magnetic fields created by speakers or large motors.
- Electromagnetic wave radiation may adversely affect this unit, disturbing the pictures and/or sound.
- If this unit is adversely affected by electromagnetic equipment and stops functioning properly, turn this unit off and remove the battery or disconnect AC adaptor. Then reinsert the battery or reconnect AC adaptor and turn this unit on.

**Do not use this unit near radio transmitters or high-voltage lines.**

- If you record near radio transmitters or high-voltage lines, the recorded pictures and/or sound may be adversely affected.

### ❖ Wi-Fi® Function

**Use of the Wi-Fi function of the camera is presumed to be in countries where it is sold.**

There is the risk that the camera violates the radio wave regulations if used in countries other than those where it is sold, and Panasonic takes no responsibility for any violations.

- Please be advised that Panasonic is not liable for any damage directly or indirectly caused by use (including use in combination with the products of other companies) or malfunction of this product.
- Please be advised that Panasonic is not liable for any damage to data caused by this product.
- The external design and specifications of this product, as described in this document, may differ from the actual product due to improvements made.

## Main Specifications

The specifications are subject to change for performance enhancement.

**Digital camera body (DC-S9):**

Information for your safety

<b>Power source:</b>	9.0 V <span> </span> ===
<b>Power consumption:</b>	3.9 W (when recording with the monitor), 3.3 W (when playing back with the monitor) [When using the interchangeable lens (S-R2060)]

Type	
<b>Type</b>	Digital Single Lens Mirrorless camera
<b>Lens mount</b>	Leica Camera AG L-Mount
<b>Recording media</b>	SD memory card / SDHC memory card / SDXC memory card
Image sensor	
<b>Image sensor</b>	35 mm full-frame (35.6 mm×23.8 mm) CMOS sensor, a total of approx. 25,300,000 pixels, primary color filter
<b>Effective number of pixels of the camera</b>	Approx. 24,200,000 pixels
Monitor	
<b>Type</b>	Aspect ratio 3:2, 3.0 inches, approx. 1,840,000 dots monitor, capacitive touch screen
Interface	
<b>USB</b>	USB Type-C® , USB 10Gbps
<b>HDMI</b>	HDMI Type D
<b>[MIC]</b>	∅3.5 mm stereo mini jack
External dimensions / Mass (Weight)	
<b>External dimensions</b>	Approx. 126.0 mm (W)×73.9 mm (H)×46.7 mm (D) (4.96" (W)×2.91" (H)×1.84" (D)) (excluding the projecting parts)
<b>Mass (Weight)</b>	Approx. 486 g/1.08 lb (camera body, with battery and card) Approx. 403 g/0.89 lb (only camera body)
Operating environment	
<b>Recommended operating temperature</b>	0 °C to 40 °C (32 °F to 104 °F)
<b>Permissible relative humidity</b>	10 %RH to 80 %RH
Wi-Fi	
<b>Compliance standard</b>	IEEE 802.11a/b/g/n/ac (standard wireless LAN protocol)
<b>Frequency range used (central frequency)</b>	2412 MHz to 2472 MHz (1 to 13ch) 5180 MHz to 5320 MHz (36/40/44/48/52/56/60/64ch) 5500 MHz to 5700 MHz (100/104/108/112/116/132/136/140ch) 5745 MHz to 5825 MHz (149/153/157/161/165ch)
<b>Encryption method</b>	Wi-Fi compliant WPA™ / WPA2™ / WPA3™
<b>Access method</b>	Infrastructure mode
Bluetooth®	
<b>Compliance standard</b>	Bluetooth v5.0, Bluetooth Low Energy (BLE)
<b>Frequency range used (central frequency)</b>	2402 MHz to 2480 MHz

**Battery pack (lithium-ion) (Panasonic DMW-BLK22):**

Information for your safety

<b>Voltage/capacity:</b>	7.2 V / 2200 mAh
<b>Power source:</b>	Li-ion
<b>Charging:</b>	Charging time: approx. 2 hours (with the optional charger)
<b>Charging method:</b>	DC

## Trademarks and Licenses

- L-Mount is a trademark or registered trademark of Leica Camera AG.
- SDXC Logo is a trademark of SD-3C, LLC.
- The terms HDMI, HDMI High-Definition Multimedia Interface, HDMI Trade dress and the HDMI Logos are trademarks or registered trademarks of HDMI Licensing Administrator, Inc.
- USB Type-C® and USB-C® are registered trademarks of USB Implementers Forum.
- QuickTime and the QuickTime logo are trademarks or registered trademarks of Apple Inc., used under license therefrom.
- The Bluetooth® word mark and logos are registered trademarks owned by Bluetooth SIG, Inc. and any use of such marks by Panasonic Holdings Corporation is under license. Other trademarks and trade names are those of their respective owners.
- "Wi-Fi®" is a registered trademark of Wi-Fi Alliance®.
- "WPA™", "WPA2™", and "WPA3™" are trademarks of Wi-Fi Alliance®.
- QR Code is a registered trademark of DENSO WAVE INCORPORATED.
- Other names, company names, product names mentioned in this document are trademarks or registered trademarks of the companies concerned.



At least three (3) years from delivery of this product, Panasonic will give to any third party who contacts us at the contact information provided below, for a charge no more than our cost of physically performing source code distribution, a complete machine-readable copy of the corresponding source code covered under GPL V2.0 or LGPL V2.1, as well as the respective copyright notice thereof.

Contact Information: [oss-cd-request@gg.jp.panasonic.com](mailto:oss-cd-request@gg.jp.panasonic.com)

The source code and the copyright notice are also available for free in our website below. <https://panasonic.net/cns/oss/index.html>

This product is licensed under the AVC Patent Portfolio License for the personal use of a consumer or other uses in which it does not receive remuneration to (i) encode video in compliance with the AVC Standard ("AVC Video") and/or (ii) decode AVC Video that was encoded by a consumer engaged in a personal activity and/or was obtained from a video provider licensed to provide AVC Video. No license is granted or shall be implied for any other use. Additional information may be obtained from MPEG LA, L.L.C. See <http://www.mpegla.com>

See <http://www.mpegla.com>

**-If you see this symbol-**

		<b>Disposal of Old Equipment and Batteries</b> <b>Only for European Union and countries with recycle systems</b> These symbols are only valid in the European Union and countries with recycle systems. If you wish to discard this product, please contact your local authorities or dealer and ask for the correct method of disposal.
--	--	--

<b>For Australia</b>
----------------------

### Panasonic Warranty

**LUMIX Camera, Digital Video Camera & Camera Accessories, 24 Month Warranty from Date of Purchase ("Warranty Period")**

- This warranty does not exclude, restrict or modify in any way other rights and remedies under the law which relates to the product, including any non-excludable statutory guarantees in Australia.
- Subject to the conditions of this warranty and during the Warranty Period, Panasonic or its Authorised Service Centre will perform the necessary service on the product without charge for parts or labour, if in the opinion of Panasonic, the product is found to be faulty within 24 months (the "Warranty Period") from the date of purchase appearing on your purchase receipt.
- This warranty only applies to Panasonic products purchased in Australia and sold by Panasonic Australia or its Authorised Distributors or Dealers and only where the products are used and serviced within Australia or its territories. Warranty cover only applies to service carried out by a Panasonic Authorised Service Centre and only if valid proof of purchase is presented when warranty service is requested.
  - Panasonic and LUMIX branded products purchased from other sources (including 'grey', 'parallel' or 'direct imports) are not covered by this warranty.
- This warranty only applies if the product has been used in accordance with the manufacturer's recommendations (as noted in the Operating Instructions) under normal use and reasonable care (in the opinion of Panasonic). The warranty covers normal, intended use only and does not cover damage, malfunction or failure resulting from:
  - misuse, abuse, neglect, accidental damage or modifications;
  - infestation by insects or vermin;
  - incorrect installation, assembly, improper voltage, or mains supply problems;
  - natural disaster or acts of God (e.g. lightning, flood, fire, earthquakes etc);
  - rust or damage caused by exposure to abnormally corrosive conditions;
  - an accessory, component or other equipment not supplied by Panasonic Australia;
  - improper maintenance by the customer (refer to the maintenance section of the Operating Instructions) which includes but is not limited to the failure to undertake regular cleaning; and maintenance.
  - incorrect operation of the product; and
  - where no actual fault of the product is determined to have occurred, during a customer-initiated service call, and where the perceived problem is explained within the Operating Instructions (including the troubleshooting section) warranty service is not applicable.

- This warranty does not cover the following items unless the fault or defect existed at the time of purchase:
  - Casing Parts
  - Noise or vibration that is considered normal
  - User replaceable Batteries
- You will be responsible for costs associated with making the warranty claim where there are costs associated with shipping or handling or travelling outside of the area normally serviced by Panasonic or any repair agent authorised by Panasonic.
- To the extent permitted by law and subject to your non-excludable statutory rights and guarantees, Panasonic excludes all warranties and liabilities (other than those contained in this warranty) including any liability for loss or damage whether direct or indirect arising from your purchase, use or non-use of the product.
- In addition to your rights under this warranty, Panasonic products come with consumer guarantees that cannot be excluded under the Australian Consumer Law. You are entitled to a replacement or refund for a major failure and compensation for any reasonably foreseeable loss or damage. You are also entitled to have the product repaired or replaced if the product fails to be of an acceptable quality and the failure does not amount to a major failure.
- To claim warranty service, when required, you should:
  - Contact Panasonic's Customer Care Centre on 132 600 for Authorised Service Centre information
  - Send or take the product to a Panasonic Authorised Service Centre together with your purchase receipt as a proof of purchase date.

**THIS WARRANTY CARD AND THE PURCHASE DOCKET (OR SIMILAR PROOF OF PURCHASE) SHOULD BE RETAINED BY THE CUSTOMER AT ALL TIMES**

If you require assistance regarding warranty conditions or any other enquiries, please visit the **Panasonic Australia** website [www.panasonic.com.au](http://www.panasonic.com.au) or contact by phone on **132 600** *If phoning in, please ensure you have your operating instructions available.*

<b>Panasonic Australia Pty. Limited</b> ACN 001 592 187 ABN 83 001 592 187 1 Innovation Road, Macquarie Park, NSW 2113 <a href="http://www.panasonic.com.au">www.panasonic.com.au</a>
PRC-031-F49 Issue: 1.0 <span style="float:right">01/04/2024</span>