

# Panasonic®

## Operating Instructions

### Water Dispenser (Household use)

---

Model No.   SDM-WD3238TG/F  
                  SDM-WD3128TG/F

---

Thank you for purchasing the Panasonic product

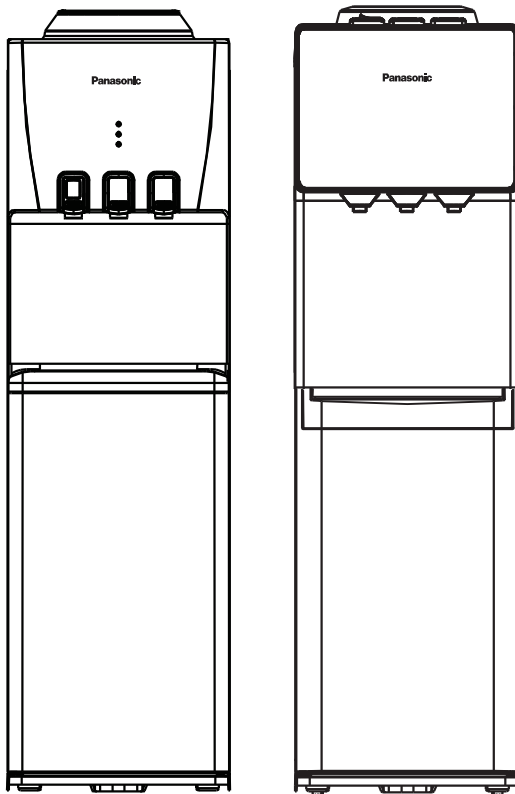

#### CONTENTS

• CARING FOR THE ENVIRONMENT .....	2
• SAFETY INSTRUCTIONS .....	2-4
• PART NAME .....	5
• MACHINE INSTALLATION .....	6
• OPERATION INSTRUCTION .....	6
• CAUTION .....	6-7
• TROUBLE SHOOTING .....	8
• CLEANING .....	8
• TECHNICAL SPECIFICATIONS .....	9

\* The picture is only for illustration.

- 
- Please read these instructions carefully and follow safety precautions before using this product.
  - Please keep product purchase documents like invoice copy with this operating instructions manual for warranty claim purpose.

## Caring for the environment

### Disposing of the packaging



Please recycle where possible (e.g. cardboard, plastic bags, adhesive tape and polystyrene) and make sure you dispose of all other packing materials safely.

Keep the packaging out of the reach of babies and young children, to avoid injury or suffocation.

### Before disposing of your old appliance

Please follow either the disposal instructions from the manufacturer of the old appliance, or local disposal regulations for the appliance. Where this is not available, please follow the three step instructions below.

1. Remove the plug from the socket.
2. Cut the supply cord off, and safely dispose of it with the mains plug still attached.
3. Until the old appliance is collected, or you take it to a Recycling Centre, make sure it's out the reach of small children.
  - Remove all sealing materials from the door and leave all the shelves and drawers in place. This way, children are less likely to climb in and become trapped.

## Safety instructions

Do not	Indicates the appliance must be earthed to prevent electric shock
Make sure you do this	Do not take apart



### Indicates risk of death or serious injury.

This appliance is not intended for use by persons (including children) with reduced physical, sensory or mental capabilities, or lack of experience and knowledge, unless they have been given supervision or instruction concerning use of the appliance by a person responsible for their safety. Children should be supervised to ensure that they do not play with the appliance.



### Do not use a multiple socket adaptor and plug several appliances into the same socket adaptor.

- This can cause overheating, fire or short circuit.

### Do not pinch, knot, or bend the supply cord, or place heavy objects on it.

- This increases the risk of fire or electric shock. If the supply cord or plug of the appliance is damaged, it must be replaced by the manufacturer, its service agent or similarly qualified person in order to avoid a hazard.

### Do not unplug the machine by pulling on the supply cord.

- This can damage to the supply cord. Always grip the plug and pull firmly from the socket.

### Do not spray inflammable gas near the machine.

- This can cause explosion or fire.

### Do not spray water onto or into the machine.

- This can cause fire or electric shock.

### Do not touch the power plug with wet hands.

- This can cause electric shock.

**Do not install the machine in a damp place, or where it may come into contact with water.**

- Deteriorated insulation of electrical parts can cause short circuit, electric shock or fire.

**Do not store volatile or flammable substances in the machine.**

- Flammable substances such as benzene, thinners, alcohol, ether and Liquid Petroleum Gas (LPG) can cause explosions.

**Do not store pharmaceuticals or other temperature-sensitive products in the machine.**

- You should not store products that require strict temperature controls in the machine.

**Do not let children climb, swing or hang on the machine door.**

- This can cause serious injury, as well as damaging the machine.

**Do not operate the machine in the presence of explosive fumes or flammable gas.**

- This can cause explosion or fire.

**Do not store petrol or other flammable liquids and vapours in the machine, or use them near the appliance.**

- This can cause explosion or fire.



**Do not use electrical appliances inside the food storage compartments of the appliance, unless they are of the type recommended by the manufacturer.**



**Do not try to disassemble, repair or modify the machine yourself.**

- You may injure yourself – or others – with burns or electric shock, or damage the machine. If your appliance needs alterations or repair, please consult authorized service centre.



**Ensure that the machine is plugged into an earthed mains socket. DO NOT plug into an unearthed mains socket.**



**Make sure the supply cord and plug are not squashed or damaged.**

- A damaged power plug or cord can cause short-circuit, fire or electric shock.
- If the supply cord is damaged, it must be replaced by the manufacturer, its service agent or similarly qualified persons in order to avoid a hazard.
- **DO NOT ATTEMPT TO REPLACE IT YOURSELF.**

**Remove any dirt or dust from the plug's pins before connecting to the power supply.**

- Dust build-up on the plug can cause insulation failure, especially in humid conditions. This can cause short circuit, fire or electric shock. Unplug the supply cord and wipe it with a dry cloth. Never use a wet or damp cloth.

**Plug your appliance into the socket, making sure the connection is secure.**

- A loosely connected power plug can cause fire or electric shock.

**Install the machine in a well-ventilated area.**

- The more refrigerant there is in an appliance, the larger the room it should be installed in. If there's a refrigerant fluid leak, and the appliance is in a small room, the build up of combustible gases is more likely. This can cause fire or explosion. As a guide, for every 8 g of coolant, you'll need at least 1 cubic metre of space in the room. The data plate inside the appliance tells you how much refrigerant your machine contains.
- Keep ventilation openings, in the appliance enclosure or in the built-in structure, clear of obstruction.

**The refrigerant (R134a) used in the machine and they also require special disposal procedures.**

- Before you dispose of the appliance, make sure none of the pipes on the back are damaged. Refrigerant or gas leaks can cause fire or explosion.
- Do not damage the refrigerant circuit.

**Unplug the machine before cleaning and servicing.**

- Failure to do this can cause electric shock.

**If you smell burning or see smoke coming from the machine, disconnect the power immediately and please consult authorized service centre.**

This appliance is not intended for use by persons (including children) with reduced physical, sensory or mental capabilities, or lack of experience and knowledge, unless they have been given supervision or instruction concerning use of the appliance by a person responsible for their safety.

Children should be supervised to ensure that they do not play with the appliance.

This appliance is intended to be used in household and similar applications such as: staff kitchen areas in shops, offices and other working environments; farm houses and by clients in hotels, motels and other residential type environments; bed and breakfast type environments; catering and similar non-retail applications.

The appliance must not be cleaned by a water jet.

The appliance is suitable for indoor use only.

**WARNING:** Keep ventilation openings, in the appliance enclosure or in the built-in structure, clear of obstruction.

**WARNING:** Do not use mechanical devices or other means to accelerate the defrosting process, other than those recommended by the manufacturer.

The appliance must not be immersed.

This series model can satisfy the need of tea & coffee and making drinking. It must be used indoor only.

With adoption of distinctive thermal isolation technology, this machine can minimize thermal exchange between hot & cold water.

Warning do not damage the refrigerant circuit.

Do not store explosive substances such as aerosol cans with a flammable propellant in this appliance.

Part name

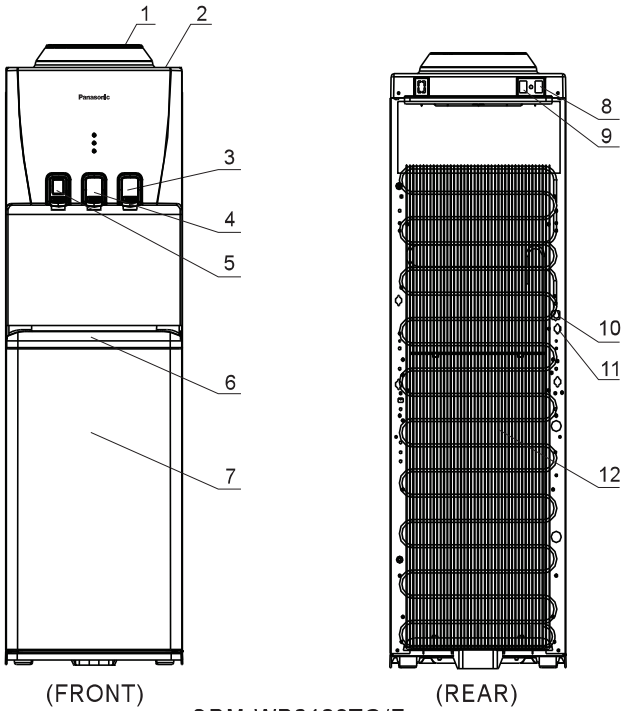

- 1. Bottle supporter
- 2. Top cover
- 3. Tap of cold water
- 4. Tap of normal water
- 5. Tap of hot water
- 6. Water collector
- 7. Door
- 8. Heating switch
- 9. Cooling switch
- 10. Power supply cord
- 11. Outlet of hot water
- 12. Condenser

SDM-WD3128TG/F

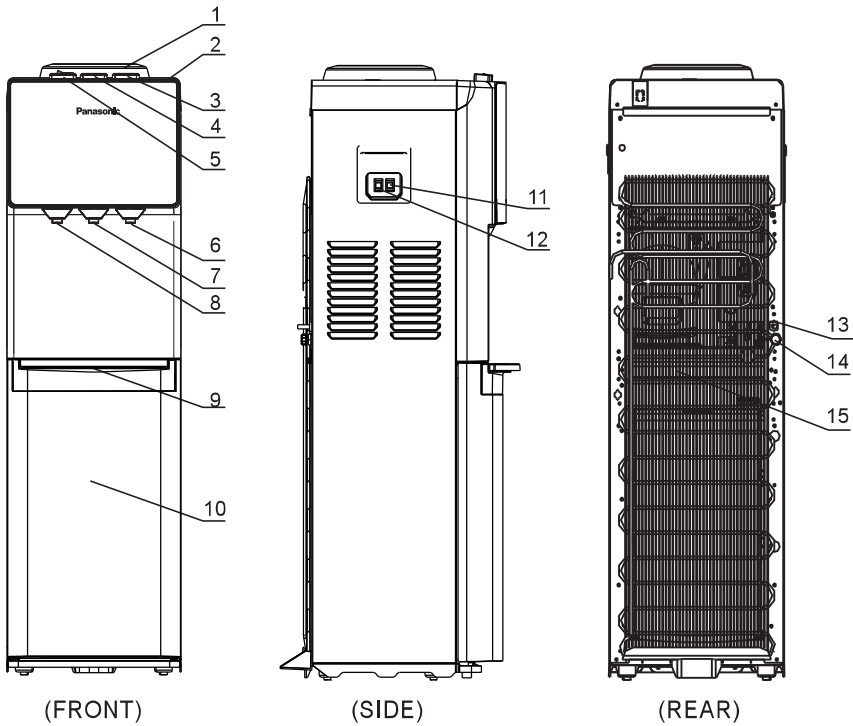

- 1. Bottle supporter
- 2. Top cover
- 3. Button of cold water
- 4. Button of normal water
- 5. Button of hot water
- 6. Tap of cold water
- 7. Tap of normal water
- 8. Tap of hot water
- 9. Water collector
- 10. Door
- 11. Heating switch
- 12. Cooling switch
- 13. Power supply cord
- 14. Outlet of hot water
- 15. Condenser

SDM-WD3238TG/F

**NOTE:** This machine is suitable for bottle of 3 or 5 gallons. Don't use unhealthy hard water.

## Machine Installation

- 1-2. Loosen the screw of the left or right bottom angle just as the picture shown.
3. Use the screw to fix the bracket on the left or right bottom angle of the water dispenser.
4. To drill a Pilot hole in concrete by Drill machine to be suitable with the plug.
5. Remove concrete debris. Plug the plug into the concrete hole if it is difficult to enter, use a hammer insert it until it becomes flat with the concrete surface.
6. Put the screw in the plug and tighten.

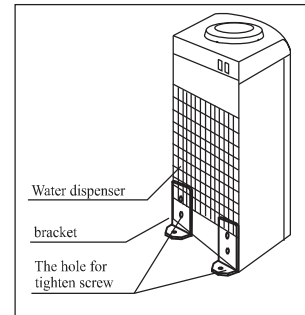
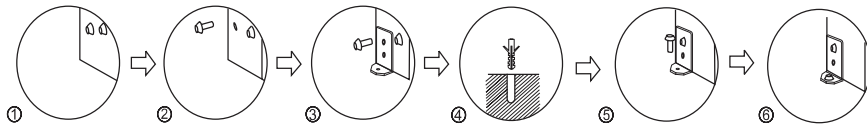

**WARNING!** To avoid a hazard due to instability of the appliance, it must be fixed in accordance with the instructions.

## Operation instruction

1. Tear the label from the bottle.
2. Vertically insert the bottle into the bottle supporter on top of the machine.  
Do not plug the power cord or push the heating switch until water runs out from the tap of hot water.
3. Insert the plug to socket, then turn on the switch. Indicators light up accordingly once the machine works.
4. Vertically pull out the bottle by two hands when the bottle is empty, then replace it with another bottle of water.
5. This appliance should work under environment of temp from 10°C-43°C.
6. This appliance is not suitable for installation in an area where a water jet could be used.
7. To dispense the normal or cold water, just press/push the button until the desired amount of water has been dispensed, then release.
8. The hot water button is equipped with a child safety lock that reduces the risk of hot water being dispensed accidentally or by small children. To dispense hot water, slide the safety lock to the left, then push/hold the dispensing button until the desired amount of water has been dispensed, then release. The hot water temperature is more than 85 °C, be careful your hands from scalding.

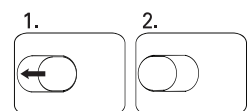
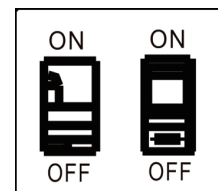
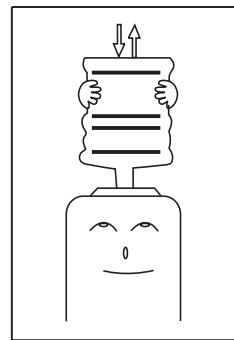

Slide Child Safety Lock to the left then push button.

## Caution

1. Keep this machine in place of dry and avoid direct sunshine. Rear of the machine should be no more than 75mm against from the wall. Never put the machine on paper or foam, which may cause unstable condition, Never put anything flammable beside this machine.

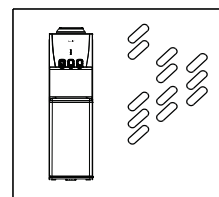

## Caution

2.To avoid damage to the machine, don't plug the power cord or push the red switch until water runs out from the tap of hot water.

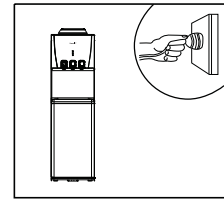

3.In case hot (or cold) water is not needed for a long time, turn off the switch accordingly to save power.

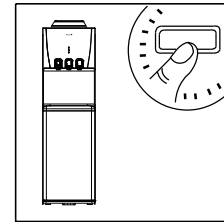

4.In case not to use this machine for a long time, turn off the switch, then pull the plug out from socket and drain the remaining water through draining outlet.

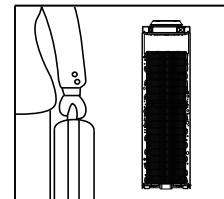

5.Never use organic liquid to clean the machine. Strictly prohibit using water to the splash it.

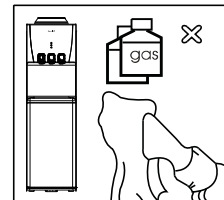

6.Never turn on (off) the machine by plugging the plug to (pulling the plug out from) the socket. Never increase the length of the power supply cord to avoid fire.

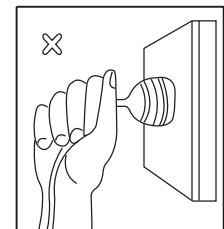

7.If the supply cord is damaged, it must be replaced by the manufacturer, its service agent or similarly qualified persons in order to avoid a hazard.

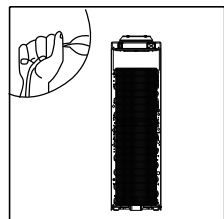

8.Never turn the machine upside-down or lean it more than 45°.

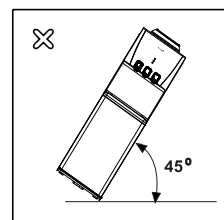

## Caution

9. When the machine is under the ice point and blocked by ice, the cooling switch must be closed for 4 hours before turning it on again to continue its operation.

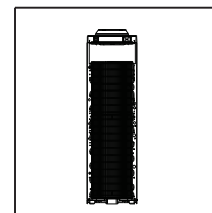

10. This machine should not be turned on until 3 minutes later after turning off the power switch.

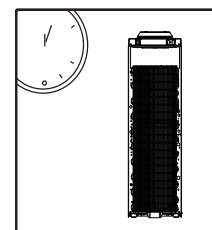

## Trouble shooting

Please check the followings before having the machine repaired

Problems	Possible Causes	Elimination
Not hot or cold water	1. Over consumption of hot or cold water in short time. 2. No power supply	1. Just wait a moment, then hot or cold water is available again. 2. Connect plug to socket, turn on heating or cooling switch.
No water running out from taps	1. Empty bottle 2. Inlet of bottle supporter blocked by bottle seal	1. Replace it with another one. 2. Clean out wasted paper & bottle seal, install bottle again
Leakage from bottle supporter	Broken bottle	Replace it with a new bottle
Noisy operation	Not placid installation	Place the machine on placid & solid surface

## Cleaning

To avoid accident, cut off the power supply before operation according to the following instruction.

1. The machine had been disinfected before departed from factory.

Cleaning the dispenser prior to installing a full bottle of water for the first time.

2. Cleaning and draining instruction:

- a) Before cleaning, make sure the power switch in the **O(off)** position and unplug the water dispenser.
- b) Vertically insert the bottle into the supporter on the top of the machine.
- c) Turn on all the taps in turn for 3 minutes after the water outflow, which completes the internal pipeline flushing.
- d) Removed the water bottle from the dispenser.
- e) Place a large bucket beneath the drain outlet. Remove the drain cover and allow water to drain.
- f) After cleaning, replace the drain cover and you can use the machine.

**Attention:** The dispenser heats water to a temperature of approximately 85°C. It can cause severe burns.

Please operation it carefully.



## Cleaning

### 3.Sanitizing

The machine should be disinfected with the disinfectant separately bought from drugstore or marketplace according to the instruction manual of the disinfectant and then clean it with water (see **cleaning and draining instruction**).

Generally this should be done every three months.

### 4.To remove mineral deposits:

Mix 4 liters water with 200g citric acid crystals, inject into the machine and make sure the water can flow out of the hot water tap. Switch on the power and heat it about 10 minutes, 30 minutes later, drain off the liquor and clean it with water for two or three times. Generally this should be done every six months.

Never disassemble this machine by yourself to avoid danger from damaged machine.

## Technical specifications

Model	SDM-WD3238TG/F	SDM-WD3128TG/F
Rated voltage	220-240V~	220-240V~
Max. current	1.0A	1.0A
Rated Frequency	50/60Hz	50/60Hz
Rated Power	520W	520W
Product Dimension(WxDxH)	310x350x1000mm	310x350x1005mm
Packing Dimension(WxDxH)	358x386x1050mm	358x386x1060mm
Net /Gross Weight	15.5kg/17.5kg	14.5kg/16.1kg
Refrigerant	R134a	R134a
Color	Black body with SS door	Black body with silver door

### NOTICE:

The packaging material used is recyclable; we recommend that you separate plastic, paper and cardboard and give them to recycling companies. To help preserve the environment, the refrigerant used in this product is R134a (Hydrofluorocarbon -HFC), which does not affect the ozone layer and has little impact on the greenhouse effect. According to WEEE (Waste of Electrical and Electronic Equipment) guidelines, waste from electrical and electronic devices should be collected separately. If you need to dispose of this appliance in the future, do NOT throw it away with the rest of your domestic garbage. Instead, please take the appliance to the nearest WEEE collection point, where available.







